

Liveable buildings

SUSTAINABLE, DIGITAL, SMART



Product-
highlights

Connecting expertise – building solutions.



Liveable buildings: sustainable, digital, smart	4
Innovative solutions for buildings	6
Sustainability at GEZE	8
Building automation	
myGEZE Control	10
myGEZE Connectivity World	12
Automatic door systems	
Revo.PRIME revolving door	14
GEZE MCRdrive sliding door	16
ECdrive T2 sliding door	18
Door technology	
TS 5000 SoftClose overhead door closer	20
GEZE ActiveStop door damper	22
FA GC 170 wireless extension	24
RSZ 7 smoke switch control unit	26
MSW Comfort manual sliding wall system	28
Sliding door system Levolan	30
Automated escape route door with hold-open system and emergency exit system	
TZ 320 door control unit stainless steel	32
Powerturn F/R swing door drive	33
GC 342+ laser scanner	33
IQ lock EL electromechanical motor lock	33
Window technology	
F 1200+ fitting drive	34
MBZ 300 N8 smoke and heat extraction system control unit	36
IQ box Safety safety module	38
Slimchain 230 V chain drive	40
Service solutions	
Services by GEZE	42
Smoke protection	
Compressed air chamber	44
Up-to-date	46

Picture credit

Titel, P. 2:	Unsplash	P. 27:	Stefan Dauth
P. 5:	GEZE GmbH	P. 31, 35:	GEZE GmbH
P. 7, 9:	Karin Fiedler / GEZE GmbH	P. 39:	Getty Images Deutschland
P. 15, 17, 19:	GEZE GmbH	P. 41:	GEZE GmbH
P. 21:	Getty Images Deutschland	P. 43:	Karin Fiedler / GEZE GmbH
P. 23:	GEZE GmbH	P. 47:	Shutterstock

160 years young

Driving forward smart solutions together!

Creating liveable buildings that are in harmony with the needs of people and nature is a great mission. Sometimes, it can also be a challenging one. We want to support you with our 160 years of experience and our development expertise for smart façades, networking solutions and natural ventilation concepts. Together, let's drive forward smart solutions for the buildings of the future, while never losing sight of the bigger picture.

Our approach: To provide optimal support to all stakeholders involved in the building life cycle and connect relevant interfaces.

Our objective: To realise liveable buildings.

Connecting expertise – building solutions.

HUNDRED+ SIXTY YEARS YOUNG



160 years microsite

Liveable buildings

Sustainable, digital, smart

A liveable building must offer enough space to feel relaxed, as well as a high level of comfort. It should also be accessible and as energy efficient as possible. Buildings are constructed in the present, for the future: today's planning, therefore, must consider the potential uses of the future. Intelligent building automation and networked safety technology pave the way to use buildings in a sustainable, safe, and comfortable way – while addressing the needs of users with the most flexibility possible.

As a global market leader in products, systems, and services for door, window, and safety technology, we present innovative and sustainable solutions. We focus in particular on options for BACnet and KNX networking for our products.

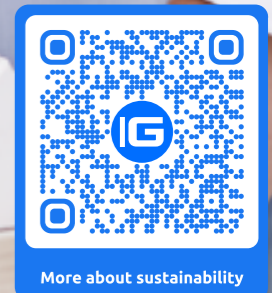

More about sustainability

Sustainability at GEZE

We take responsibility

We are a family business with a 160 year history, long-lasting products, a unique culture of appreciation, and long roots in our region – we have always thought and acted in a sustainable manner, and are aware of our responsibility for people, the environment, and the region.

We believe sustainability is elementary

For us, sustainability is more than just a strategy or an empty phrase; as a family business, we have always considered it one of our fundamental business principles, and integrated it more and more over time into all of our processes and into the entire product portfolio.

Product – Planet – People

We attach great importance to meeting and exceeding statutory requirements, and taking on responsibility in a holistic way.

Because of this, we are pursuing a sustainable transformation with concrete goals and activities in these three overarching action areas:

Product:
Sustainability along the product life cycle

Planet:
Climate & environment

People:
regional responsibility in the global network



” As a family business, we have always concentrated on long-term concepts, instead of short-term profits. Sustainability influences our everyday actions along the entire supply chain – from the purchasing of our raw materials to recycling and waste management.

Sandra Alber, Chief Officer Legal & Finance



New!

myGEZE Control

The next generation of networking

With myGEZE Control, we bridge the gap in building automation with a smart solution for networking door, window and safety systems. The myGEZE Control connectivity platform with modular software and open interfaces heralds completely new approaches to building automation for planners and operators everywhere.

- For greater efficiency, safety and comfort
- For dynamic safety and fire protection concepts, intelligent smoke and heat extraction and the targeted release of escape routes
- For more networking options

The central device is a standard control unit (PLC). The hardware components consist of an embedded PC control system that has a certified BACnet communication interface. myGEZE Control can be integrated into building management system, danger management and CAFM systems from any manufacturer. In addition, stand-alone visualisation solutions for GEZE product systems are made possible by the myGEZE Visu software option.

The advantages of the new platform: Automated processes and central monitoring make the system easier, more comfortable and safer to use – while also enabling energy-efficient operation of the entire building. So you have complete control!

COMPACT

- Efficient and safe building automation system for GEZE products
- Up to 200 GEZE products can be connected, depending on the hardware configuration
- Secure data exchange via the BACnet and KNX communication standard
- BTL certified in accordance with BACnet standard ISO 164845
- High-performance hardware for installation in control cabinets (top hat rail mounting)
- BACnet device profile BACnet Building Controller B-BC

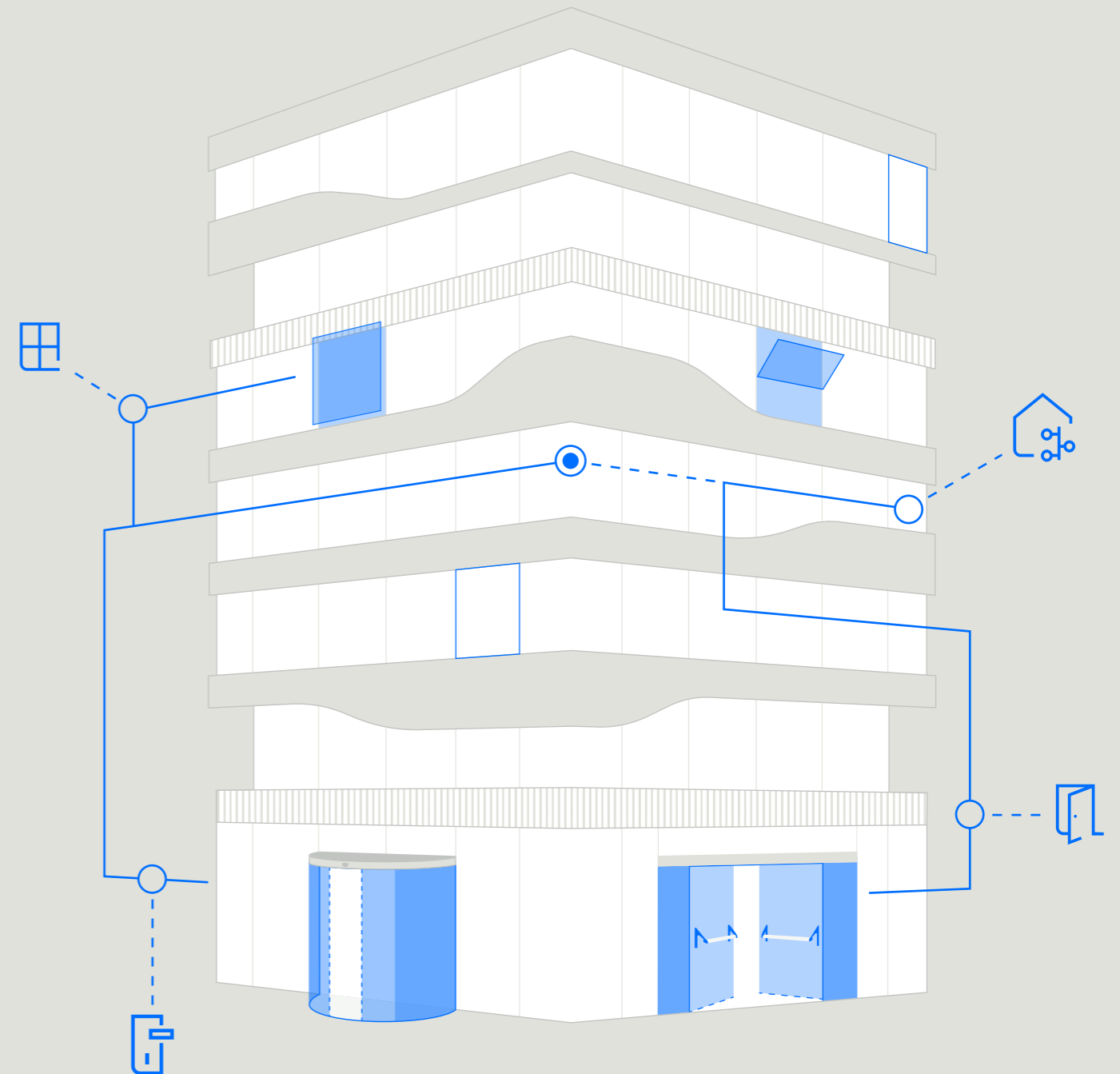

myGEZE Control

myGEZE Connectivity World

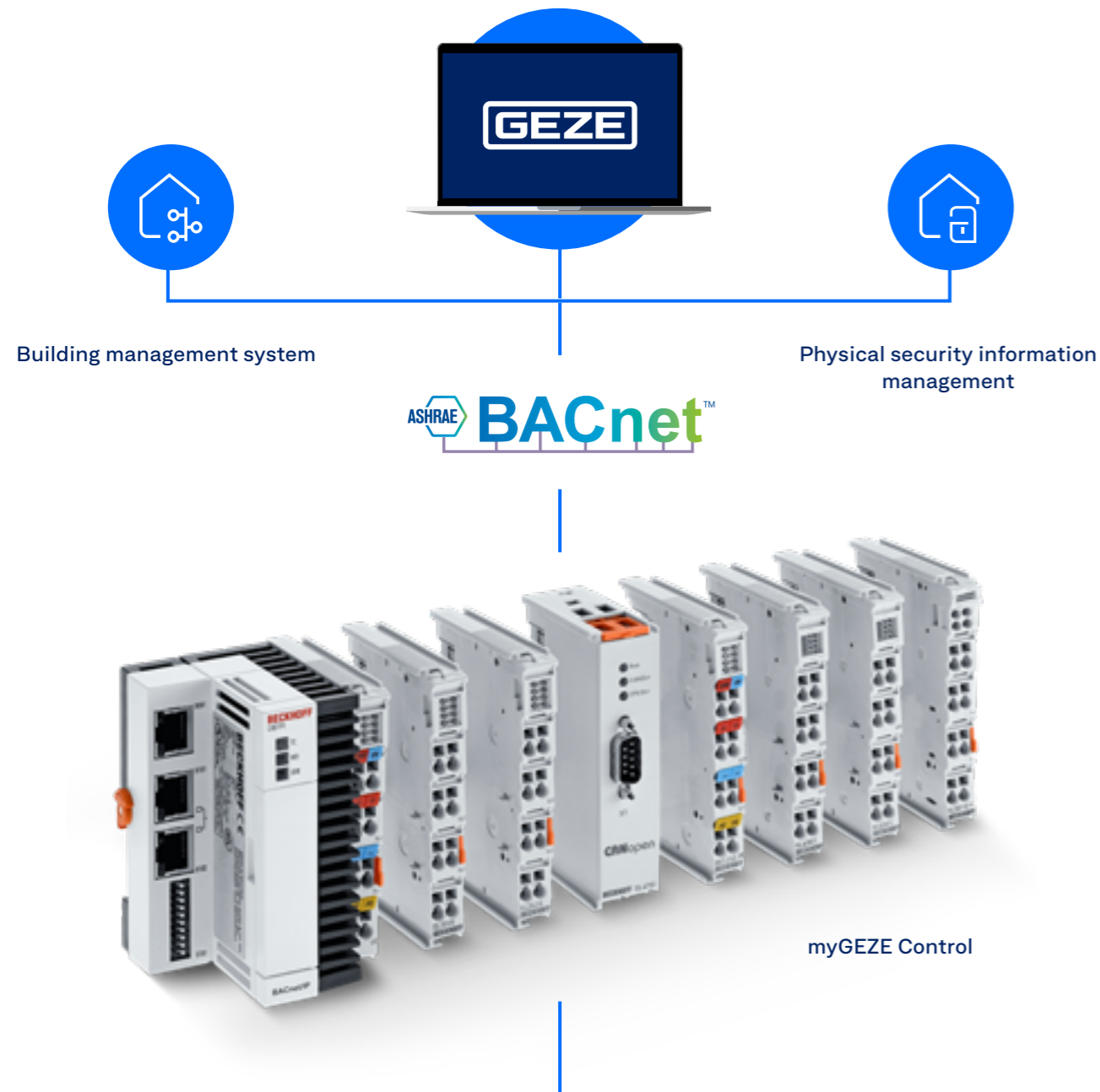

EMERGENCY EXIT SYSTEM (RWS)



SMOKE AND HEAT EXTRACTION SYSTEM

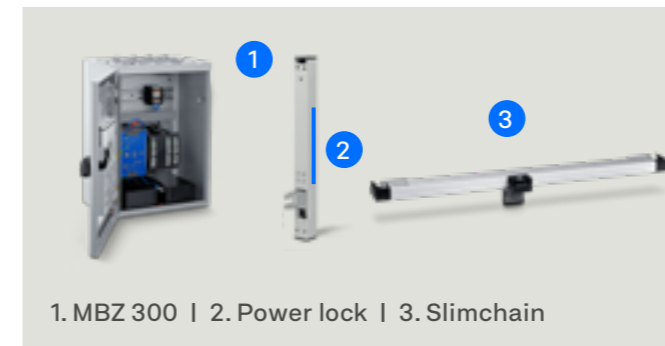

FIRE PROTECTION DOORS WITH HOLD-OPEN SYSTEMS



NETWORKED DOOR SYSTEMS



NETWORKED VENTILATION CONTROL





Revo.PRIME revolving door

Maximum design appeal – minimum canopy height

The most beautiful way to say welcome: The sophisticated Revo.PRIME revolving door plays the starring role when it comes to creative freedom and transparency in the entrance area of your building. A minimum canopy height of just 75 mm and a barely visible drive unit make this possible. And that's not all: with a narrow profile system of just 60 mm, this revolving door really steals the show.

Advanced drive technology ensures maximum ease of access and safety when passing through the door. And because energy is precious, this system runs with low energy consumption, and stands out in terms of sustainability thanks to excellent insulation against draughts, weather, and noise. The automatic revolving door system with low canopy height and narrow profile system is suitable for three- or four-leaf doors.

COMPACT

- Very quiet-running, low-wear drive solution with a canopy height of just 75 mm
- Precise closing between door leaves and side walls
- Adjustable automatic speed to suit the number of people passing through
- Door can be operated manually, e.g. for carrying out cleaning work
- Connectible, and can be integrated into the building automation via open standard (BACnet)
- Freely configurable parameter setting inputs and outputs for different functions



red dot winner 2022



GERMAN DESIGN AWARD WINNER 2022





GEZE MCRdrive automatic sliding door system

Modular and hermetic system solution

With the GEZE MCRdrive, we offer a modular sliding door system for building areas with hermetic air tightness requirements. The special feature: GEZE MCRdrive offers functional design safety thanks to a standard-compliant and certified system.

The sliding door system was specially designed for use in access areas of operating theatres, quarantine rooms and intensive care areas in healthcare, laboratories of research institutions as well as in the pharmaceutical

industry. With the new GEZE MCRdrive, air permeability classes according to EN 1026 / EN 12207 B + C can be achieved. In addition, the sliding door system fulfils sound insulation requirements according to EN 4109 of 37 dB. The system is TÜV type-tested according to EN 16005. Radiation protection according to DIN 6834-1 can be implemented by means of a lead insert. GEZE MCRdrive works reliably at ambient temperatures from -15° C to 50°C.

COMPACT

- Hermetic door system with air permeability certification according to EN 1026 / EN 12207 class B + C.
- Maximum customer individuality and flexibility through modular design
- Universal profile system for glass, HPL or stainless steel door leaves
- Modern and appealing design concept for new building objects
- Easy to assemble and maintain sliding door system due to assembly tolerances





ECdrive T2 sliding door system

Efficient and functional

Automatic sliding doors provide comfortable passageways wherever many people converge. The continued development of the reliable ECdrive sliding door solution offers new advantages, especially for the demands of very large and wide doors. The optional double roller carriage increases the leaf weight to up to 140 kilograms. This increases the leaf area by nearly 20 per cent – and provides real "eye-catchers", for instance in shop fronts. A reinforced track also improves the running properties.

The cover height of the drive has been reduced to a slim and elegant 100 millimetres. Installation and alignment are quick and easy thanks to pre-drilled tracks and oblong holes in the tracks.

The ECdrive T2 can be combined with the fine-framed, energy efficient GCprofile Therm and a thermally separated fanlight. This ensures optimal thermal insulation and is yet another design highlight, thanks to the sophisticated profile.

COMPACT

- Slimmer cover height of 100 mm
- Reinforced track for better running properties
- Can be combined with fine-framed, energy efficient GCprofile Therm and thermally separated fanlight
- New service interface for simple maintenance
- Increased load bearing capacity for leaf weight up to 140 kg
- Tested in accordance with the AutSchR, DIN 18650-1/2 and DIN EN 16005



Learn more



TS 5000 SoftClose overhead door closer

Quiet, powerful and accessible

Reliable door closing –even in unfavourable environments: the new GEZE TS 5000 SoftClose door closer convinces with its excellent flexibility. Depending on demand, a latching action can be set, or the door leaf can be slowed down to the last opening degree. Thanks to this optimised closing process, the door is still pulled safely into the lock with consistent power. This way, doors close safely and gently, even in difficult conditions such as wind and draught, in areas such as underground parking garage interlocking door systems or staircases.

The TS 5000 SoftClose door closer also is the right choice whenever you need doors to be closed quietly and safely - whether in clinics, hotels or apartment buildings.

By damping the door shortly before the closing position is reached, doors don't bang when they close. The latching action speed can be regulated easily and flexibly via a valve. The new variant also satisfies the specifications of the DIN 18040 standard for barrier-free building up to a leaf width of 1,100 mm.

Since the new door closer is compatible with all variants in the GEZE TS 5000 series, existing solutions can easily be replaced, without this requiring additional components. It can also be used with all types of guide rail.

COMPACT

- Reliable, gentle closing, even in unfavourable conditions (e.g. underground parking interlocking door systems)
- Variably adjustable closing speed in the latching action area
- Suitable for different system variants
- Can be used flexibly (e.g. leaf or transom installation, hinge or opposite hinge side, etc.)
- Simple exchange with all TS 5000 series variants
- Accessible in accordance with DIN 18040, for leaf widths up to 1100 mm



Learn more



GEZE ActiveStop door damper

Same safety – more door control

Rooms can be entered more comfortably than ever before. GEZE ActiveStop ensures controlled and damped opening, closing and holding open of room doors. This door damper can be integrated discreetly into the door leaf or retrofitted onto the leaf, by being glued to it. It can also be removed easily subsequently. This protects the door as well as walls and furniture.

Whether with a gentle or energetic push – GEZE ActiveStop independently opens doors up to the hold-open position, which can be set individually at between 80 and 140 degrees. Doors are slowed down in good

time, and remain open securely in the desired position. Thanks to active damping, they close gently and quietly when they reach about 25 degrees. Doors run freely at between 25 and 60 degrees. They are stopped securely from 25 or from 60 degrees. GEZE ActiveStop also keeps doors closed safely and autonomously. No lock latches are needed.

The door damper has already received multiple awards for outstanding design, such as the Singapore Good Design Award, German Innovation Award and Iconic Award.

COMPACT

- Soft opening and closing of doors up to max. 45 kg leaf weight
- Custom back check between 60 and 140 degrees, for glass doors up to 110 degrees
- Door opening angle with variable adjustment from 80 to 140 degrees, for glass doors up to 110 degrees
- Safe damping in the direction of closing from 25 degrees
- Surface-mounted variant for flexible retrofitting of glass and timber doors
- Integrated variant: discreet integration into the door leaf, installed depth just 28 mm



Learn more



FA GC 170 wireless extension

Clever components for hold-open systems

The **GEZE FA GC 170 wireless extension** connects the ceiling-mounted detector and manual trigger switch wirelessly with the lintel-mounted detector of GEZE hold-open systems. Separate cable-laying is no longer needed. This facilitates planning, in particular in listed buildings. In addition, the solution can easily be retrofitted. The system has been tested in accordance with the European DIN EN 54-25 standard for fire alarm systems. The long battery life of five years ensures low maintenance costs.

Double award-winner: The expert jury of the German Design Award 2019 honoured the wireless extension with a "Special Mention" in the Building & Elements category. At the ICONIC AWARDS 2018 Innovative Architecture, the FA GC 170 received the "Selection" award in the Product category.

COMPACT

- Wireless connection of ceiling-mounted detector and manual trigger switch with the lintel-mounted detector
- Optimised for all GEZE hold-open systems
- Simple planning and uncomplicated retrofitting
- Quick and easy connection with the DIP switch
- Low servicing costs, thanks to a long battery life of 8 years

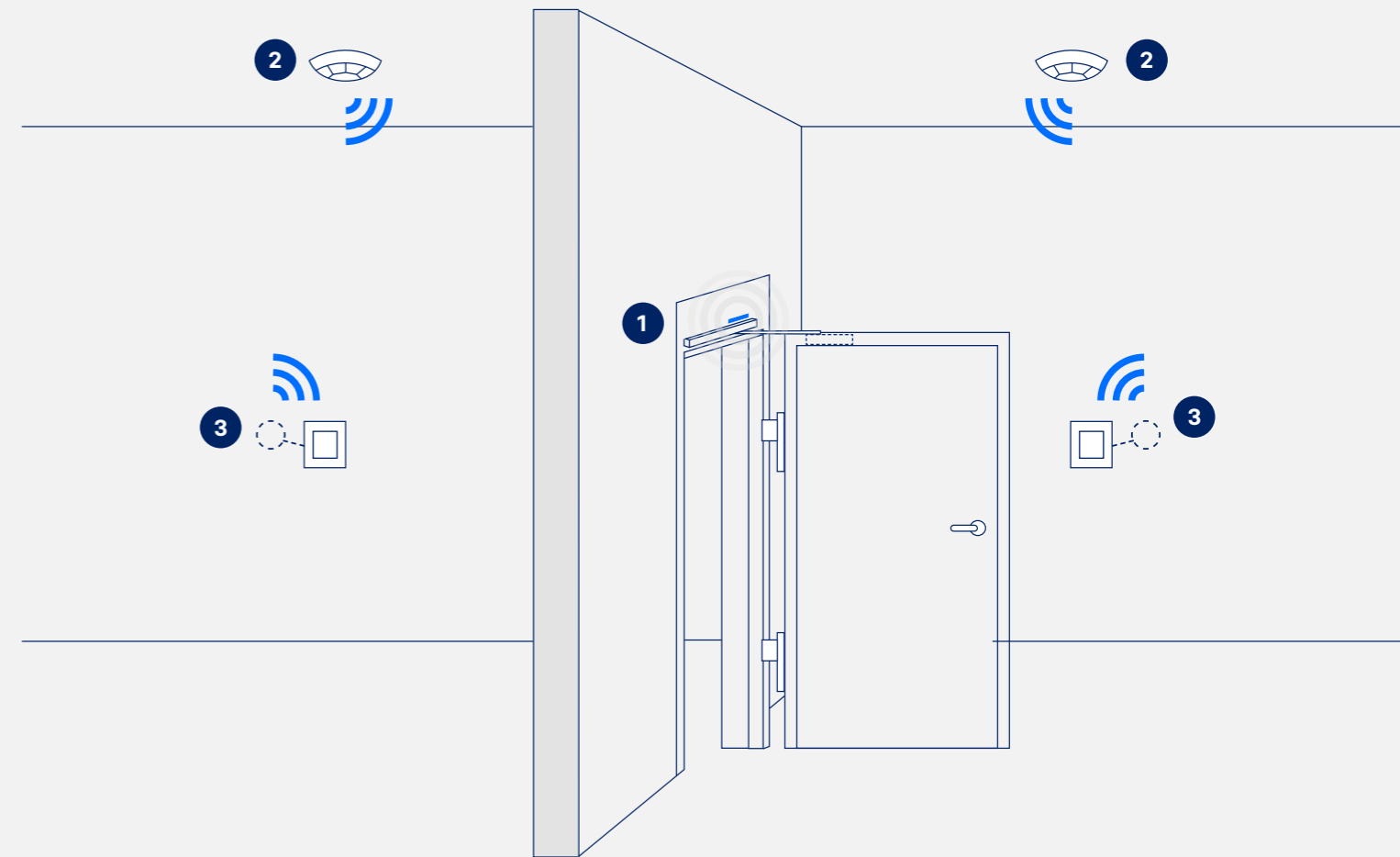

EXAMPLE OF A HOLD-OPEN SYSTEM WITH WIRELESS OR WIRED COMPONENTS

- 1a** Power supply for hold-open device/ trigger mechanism, e.g. R guide rail
- 1b** TS 5000 Ecline door closer
- 1c** GC 171 wireless module
- 2** GC 172 / GC 173 wireless ceiling-mounted detector
- 3** Manual trigger switch with GC 175 wireless input module



Learn more



RSZ 7 smoke switch control unit

Completely flexible!

Secure solution for unfavourable lintel situations, which, for example, leave too little space above the smoke chambers: The RSZ 7 smoke switch control unit has a telescopic function. The smoke detector can be extended, thus allowing overhangs of about 30 mm to be bridged.

The smoke switch control unit is connected to the 230 volt power network via the integrated power supply, and it reliably supplies each connected GEZE hold-open device with a 24 V direct current (DC). The control unit is attached to the vertical wall above the active leaf, enabling early fire and smoke detection.

In the event of an alarm, the power supply to the hold-open devices is interrupted and the doors close immediately. Two additional ceiling-mounted detectors, or the FA GC 170 wireless extension components, can be connected if necessary. The integrated smoke switch comes with an automatic adaption of the alarm threshold, which offsets minor smoke chamber contamination – and so increases the lifespan of the smoke switch control unit 7.

COMPACT

- Extendable smoke switch control unit for all GEZE hold-open devices
- Telescopic function for bridging overhangs of up to 30 mm
- Automatic adaption of the alarm threshold, including contamination indicator
- Visual display of current RSZ 7 status
- Additional smoke switches can be connected



Learn more



MSW Comfort manual sliding wall system

Clear design – convenient and safe

The automatic locking concept for manual sliding wall systems (MSW) ensures even more convenient and safe operation, for example in upscale shop fitting. MSW Comfort uses an activator unit to lock both the glass panels in the floor and the panels together. This means that manual sliding wall systems can be automatically locked and unlocked, simply, comfortable and with little physical effort – all without manual operation of the manual locking device.

This makes the opening and closing of system fronts even faster. Convenient operation is even possible for segmented system fronts with a directional change from sliding panel to sliding panel of up to 15 degrees. A clear design is easily achieved since no locking elements are visible from the front. The new vertical locking mecha-

nism on the last sliding panel makes operation even more user-friendly. The SmartGuide technology makes MSW systems that are completely opened and not parked visibly in the system front even more convenient.

Your planning partner— We will support you in all stages of the project with our apps and tools. Using our configuration tool, MSW systems can be comprehensively planned with only little information. Automatically generated layout and detailed drawings simplify system installation, and the time it takes. The configured manual sliding wall systems can then be ordered directly and conveniently via our client portal.

COMPACT

- Safe locking and unlocking of shop fronts
- Automatic locking and unlocking sliding panels in the floor, and among each other
- Fast and comfortable locking and unlocking, with reduced physical effort
- Clear design, without visible operating elements
- Reduced amount of time needed for opening and closing system fronts
- No manipulation of the locking layout possible from the outside



Learn more



System components for Levolan sliding door fitting system

Elegant design even easier to assemble

The compact Levolan sliding door system is the sophisticated solution for creating functional and effortlessly moving manual sliding doors for internal applications. With its discreet appearance, and the compact dimensions of the entire hardware system, Levolan can be integrated into any architecture and installation situation. Thanks to the compact, modular design, Levolan 120 is no larger, yet carries twice the load of its “little brother” Levolan 60, making it an optimal solution for heavy door leaves. All-glass or timber sliding doors with door leaf weights of up to 120 kilograms can easily be elegantly designed, and effortlessly moved. The Levolan Smart fix installation system makes installation quick and easy, with only an Allen key and an open ended spanner needed for securing.

New system components now make installing and adjusting the entire sliding door fitting system much easier. This means that existing and previously installed sliding door fitting systems can be retrofitted without dismantling the fitting and/or sliding panel. For example, the new cover panel brackets can be installed, positioned and fixed with the Levolan Smart fix assembly system by placing them in the assembly groove at the front. An improved spacer between the end stop and adjustable trigger is easily clipped into the track and always creates the right distance for the draw-in damping.

COMPACT

- Adjustable trigger for Softstop draw-in damper
- Screw-in, positionable cover panel brackets
- Integrated impact derailing protection
- Downwardly compatible with existing Levolan 60 and Levolan 120 systems
- Successful testing of Levolan 60 and 120 systems in accordance with DIN EN 1527:2019 standard



Learn more

Emergency exit system

Automated emergency exit with hold-open system and emergency exit system

The myGEZE Control building automation system enables the release of emergency exit protections (RWS). Door control units, such as the GEZE TZ 320, can be monitored and return error messages and alarm statuses.



New!
EN 13637

Door control unit

TZ 320

- Full-surface impact cover ensures safe activation
- Coloured connectors facilitate electrical connection
- Freely configurable parameter setting inputs and outputs offer numerous options for additional components
- Number of inputs and outputs can be extended
- Tested and certified in accordance with EN 13637



Automatic swing door drive

Powerturn F/R

- Drive for single and double leaf swing doors
- Statement of approval for heavy fire protection doors
- Smoke switch control unit integrated invisibly in the cover
- Smart swing function for easy manual access
- Opening and closing even under adverse conditions (wind, suction, etc.)
- Installation is fast and easy
- Leaf widths up to 1,600 mm or leaf weight up to 600 kg
- Construction height of just 7 cm

Laser scanner

GC 342+

- Compact and space-saving safety sensor
- Use on doors up to 1600 mm leaf width
- Integrated object and wall blanking
- Protection area on the main closing edge is automatically expanded depending on the door angle
- Automated teaching of the system with the push of a button



Electronic motor lock

IQ lock EL

- Motor lock for single leaf swing doors
- Cross latch construction for quick, jarring-free unlocking
- Different modes of operation (e.g. permanently night, hold open, etc.)
- Evaluation of potential-free contacts
- Forwarding to a monitoring system

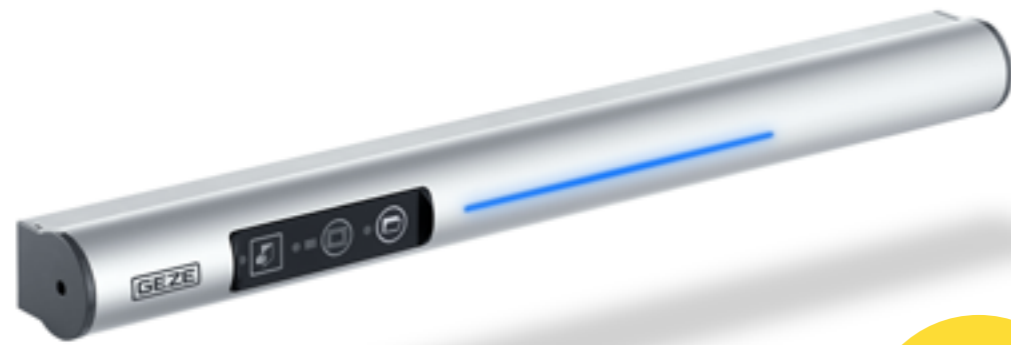

New!

F 1200+ window drive

Safe and easy operation of heavy windows

Modern façade design calls for floor-to-ceiling window elements that create maximum daylight and comfort in indoor areas. The F 1200+ is the optimal solution for comfortably opening and locking even particularly large windows. The F 1200+ has a very powerful geared motor that can turn and tilt even heavy window elements up to 200 kg leaf weight – and it is exceptionally quiet. The F 1200+ can be integrated in combination with the IQ box KNX into the room automation and building management system in an intelligent manner. This makes it possible to realise automated ventilation

scenarios like night-time cooling. The intuitive operating concept allows even people without instruction, for example hotel guests, to operate the windows quickly and with ease. A proximity sensor activates the control panel as soon as a person approaches. The capacitive touch buttons and an LED display make operation a piece of cake. Installation of the F 1200+ is simple; it can be simply mounted thanks to the surface-mounted variant.

COMPACT

- 3-in-1 function: Simple swinging, tilting and locking combined in one drive
- Powerful drive for sliding panels up to 3.5 m in size and 200 kg
- Intuitive operation thanks to user feedback, even for untrained users
- Capacitive operating unit with integrated proximity sensor for simple and safe operating comfort
- Easy commissioning and retrofitting (Retro-Fit)
- Protection against improper operation: Incorrect operation is prevented
- User authorisation: Turning position is only accessible to authorised users if desired



Learn more

SHEV control panels

Smoke and heat extraction system

The modular MBZ 300 SHEV control panel takes over control of the smoke and heat extraction system. Combined with the GEZE bus interface module, the MBZ 300 can be integrated into the building management system and implement a wide range of ventilation scenarios.



Flexible control unit

MBZ 300

- Bus control panel in the case of fire and daily ventilation
- Takes over the power supply to all connected opening systems when smoke and heat extraction is needed and ensures their coordination and monitoring
- Flexible modular design, can easily be extended
- Mapping of complex smoke and heat extraction scenarios
- Configurable ex-works as an individual solution
- Can be used as a central control unit or in the form of multiple networked control units



Smoke detector for GEZE SHEV control panels

GC 162 RWA + GC 163 RWA

- Smoke detector with scattered light evaluation
- Service life up to 8 years thanks to automatic dust and dirt compensation
- Simple testing using integrated magnetic sensor
- LED for displaying state
- Tested in accordance with EN 54

SHEV button

FT 4 A

- Robust, lockable die-cast aluminium housing
- LED operating status displays Alarm, Window OPEN, Operation OK, Fault
- Reset button for resetting the alarm
- Verifiable release by snapping of push button



SHEV control panels

THZ N4 and THZ Comfort N4

- Plastic housing (THZ) or metal housing (THZ Comfort) with integrated smoke and heat extraction system and ventilation buttons
- Compact staircase control panels with an output power of 4.5 A
- New connector for the motor line makes wiring considerably easier
- Individual adjustment with parameter settings (ST 220 interface)



IQ box Safety safety module

Safe ventilation with power-operated windows

The IQ box Safety is a product solution for safe ventilation. With the IQ box Safety as a maximum safety TÜV-tested solution, power-operated windows can be secured up to protection class 4. The IQ box Safety is suitable for closing edge protection on automated windows with drives from the 24 V IQ windowdrive series, and enables the connection of safety edges and non-contact sensors. One IQ box Safety connects up to four window drives and two locking drives per window. It is suitable for natural ventilation and smoke and heat extraction, and for all activations (e.g. SHEV control panel, 24 V power supply, KNX, IQ gear). It thus offers planners and architects high flexibility and creative freedom when designing ventilation and smoke and heat extraction system windows.

COMPACT

- Complies with highest protection class requirements in accordance with Machinery Directive protection class 4
- TÜV-tested functional safety in accordance with DIN EN 13849-1
- Easy and quick commissioning thanks to default standard parameters
- Four sensor connections, can be assigned to safety edges and/or non-contact sensors
- Top hat rail module with plug-in terminals for quick and easy wiring
- Integrated push button for closing windows manually during servicing



Learn more



Slimchain 230 V chain drive

Simple natural ventilation

It is the slim all-rounder: the GEZE Slimchain chain drive is now also available as a 230 volts variant. Thanks to the 230 volt connection with cable plug, the drive can be installed quickly. The newly installed service cover makes servicing and maintenance even easier. Its slim, compact design allows the Slimchain to be inserted discreetly into the façade. Nothing stands in the way of comfortable, natural ventilation – in schools, offices or sports halls, or even within the comfort of your own home.

The 230 V chain drive is available in the 200, 300, 500 and 800 millimetre stroke variants with parameter setting adjustable intermediate lengths. This means that it can be adjusted to different window sizes and opening requirements. Intelligent electronics allow the drive stroke and the opening speed to be set individually.

COMPACT

- Concealed 230 V cable line-feed to drive
- Different stroke variants of 200 mm, 300 mm, 500 mm and 800 mm
- Individually-adjustable drive strokes and speeds
- Simple and fast assembly with the smart fix installation system
- Service cover for easy maintenance
- Direct drive connection via a connection terminal with cable plug

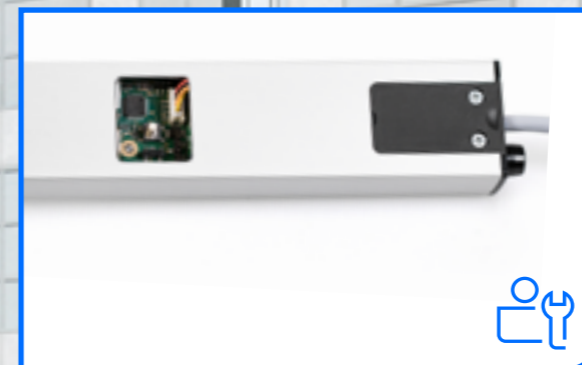

Learn more

Services provided by GEZE

Fast, efficient and reliable

Customer satisfaction takes top priority at GEZE. From initial consultation through customised customer solutions to commissioning, regular after-sales service and training: Services from GEZE guarantee reliable planning and reduce your day-to-day effort and costs.

Data packages for LogiKal (Orgadata): efficiency for planning. Planners and metal processors can also access GEZE product data when planning, calculating and constructing façades. The LogiKal software solution from Orgadata optimises planning and manufacturing processes, and saves time and costs. The technical data for GEZE products can easily be included in the calculation and planning as package solutions at the click of a mouse, and integrated in further manufacturing processes. Special wishes can also be accommodated without any problem. This means that even technically perfect complex systems can be planned and manufactured without complications.

GEZE Customer Solutions: Freedom of design with special solutions. With GEZE Customer Solutions, customers benefit from sophisticated, individual and special solutions that offer the best possible safety and convenience. And all from a single source. A central contact person is available for any questions, from the initial idea through to commissioning. Whether it's about special building requirements, traffic access applications, or solutions for machinery and plant. Customised solutions from GEZE meet every requirement.

COMPACT

- Optimum planning and manufacturing processes
- Flexible choice and composition of GEZE products
- Broad scope of functions and simple handling
- Efficient and precise planning and production of solutions to match requirements

COMPACT

- Sound advice for individual requests, national and international service
- Compilation of customised, cross-product (special) solutions e.g. for buildings, ships, trains, transport vehicles or machines
- Coordination of the interfaces in case of specific demand
- One central contact person to answer all your questions



More Services

Smoke protection pressure systems compressed air chamber

Accessible fire protection, self-rescue for all!

Fire and smoke protection closers with pressurisation are a unique planning challenge – in particular when they are located in escape and rescue routes and also need to be used in a barrier-free manner. One basic question is whether the doors need to be usable in a barrier-free only in everyday operation, or if barrier-free self rescue is also required.

The door leaf dimensions, closing force settings on the door closer and differential pressure need to be coordinated during the planning process. On the one hand, operating forces according to the barrier-free standard series DIN 18040 (25N/47m) or the workplace regulation ASR V3a.2 (25N) may not be exceeded; on the other, the doors always need to close safely.

We can differentiate between two installation situations:

- Opening the door against pressure
- Closing the door against pressure

The later this coordination takes place, the more planning work may be required – there is even a risk of non-acceptance, or a risk that previously installed components or the entire door element may need to be replaced.

Because of this, GEZE supports you during the design phase in determining which of the installation situations the given planning requirements can be implemented in, and with which door closer or drive, in order to find the most economical situation.

COMPACT

Solutions for barrier-free building and planning:

- TS 5000 ECLine up to closing force size 5 (doors up to 1,250 mm) according to DIN 18040
- EMD-F automatic swing door drive in servo mode up to 1400 mm
- Compliance with international standards, for example BS8300, ADA or NEN 1814
- Barrier-free design also possible according to ASR V3a.2

COMPACT

Solution for pressure-ventilated safety stairwells with functional integrity of the drive:

- Design of the required system by GEZE (including wiring diagram, functional description, control unit, cable plan, etc.).
- Needed by the client: Fire protection concept with described request for functional integrity
- Authorisation via project-specific building approval needed (should be applied for during the planning phase)

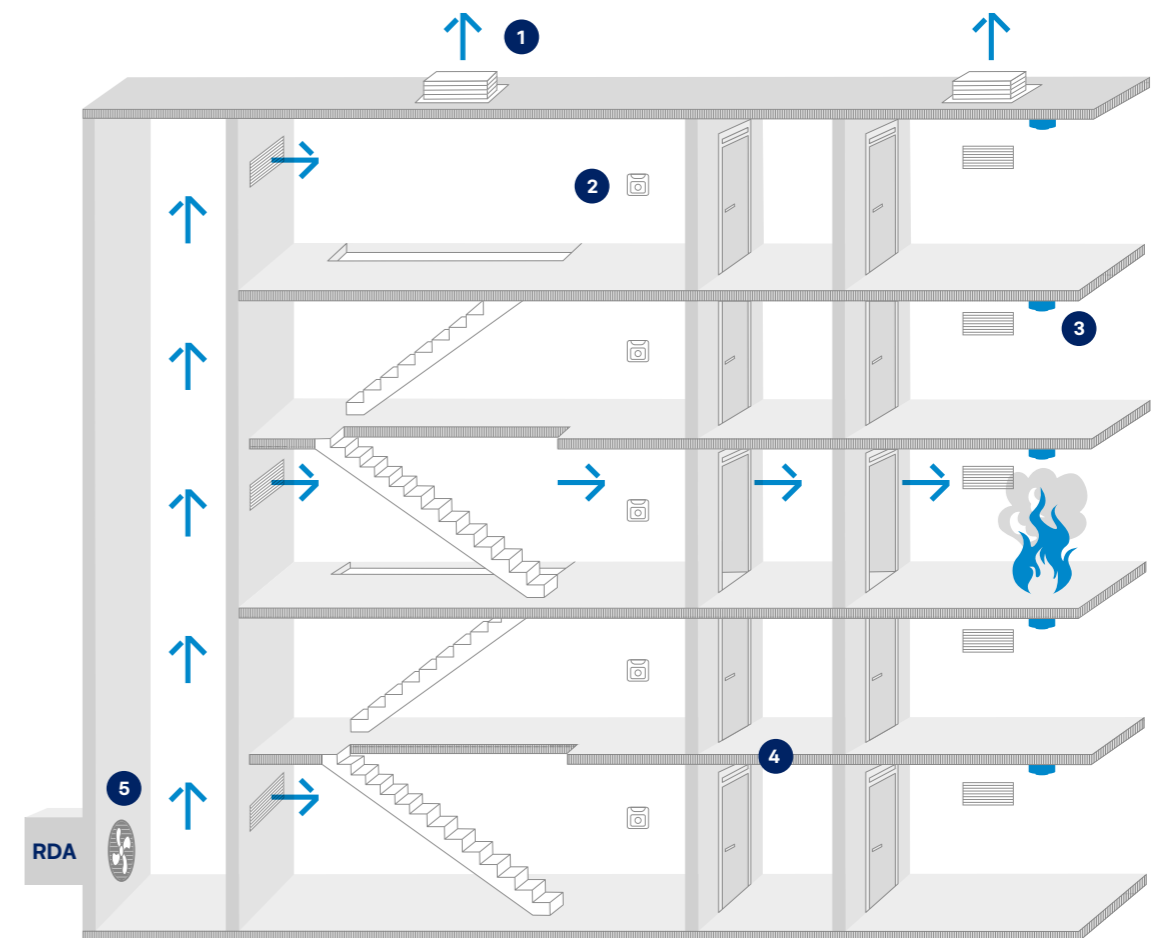

1. Pressure relief | 2. Manual release | 3. Smoke detector
4. Door closer or automatic swing door drive | 5. Fan

SUBSCRIBE

Stay up-to-date

From fascinating use cases about liveable buildings and building technology to updates on upcoming trade fairs, events and the latest news and facts about our door, window and safety technology – subscribe to our monthly newsletter and keep up to date with trends in the construction industry! Enter your details to make sure you don't miss a thing.

Register for the newsletter now!



You can also receive the latest news via our social media channels: follow us!



