





# CCN – Conference Center North Messe München

## DETAILS CONFERENCE ROOM C65

including technical specifications and seating configurations

Areas/ rooms	Area/ in m <sup>2</sup>	 Theater	 Classroom	 Banquet	 U-shaped	 Block
C65	70	72	30	–	24	28

### Room C65: Perfect for Events with up to 72 guests

This room on the first floor is particularly suitable for smaller lectures, presentations, meetings and group work. It has 70 m<sup>2</sup> and fits up to 72 guests in theater seating. Other seating arrangements are possible, but require authorization from the fire department. The equipment includes media technology, lighting and a cloakroom rack.

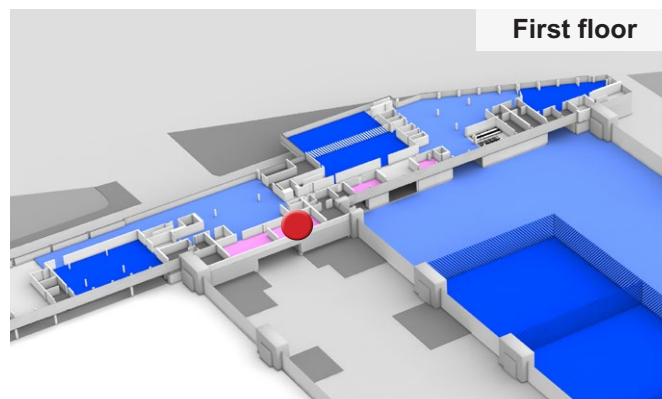

### Specifications

Seating	<ul style="list-style-type: none"> <li>■ Theater seating for up to 72 guests</li> </ul>
General information	<ul style="list-style-type: none"> <li>■ Daylight</li> <li>■ Parquet floors</li> <li>■ View into the loading yard</li> <li>■ Direct access to conference room C55 possible</li> </ul>
Communication equipment	<ul style="list-style-type: none"> <li>■ W-LAN architecture (extra bookable)</li> </ul>
Screens	<ul style="list-style-type: none"> <li>■ 80 inch monitor</li> </ul>
Media equipment	<ul style="list-style-type: none"> <li>■ Technical equipment can be controlled via wall panel</li> <li>■ Digital room signage</li> </ul>
Permanently installed media technology	<ul style="list-style-type: none"> <li>■ Floor tanks with power and network cables in the room</li> </ul>
Lighting	<ul style="list-style-type: none"> <li>■ Darkening possible with electric blinds</li> </ul>

# CCN – Conference Center North Messe München

## CONFERENCE ROOM C65: EMPTY

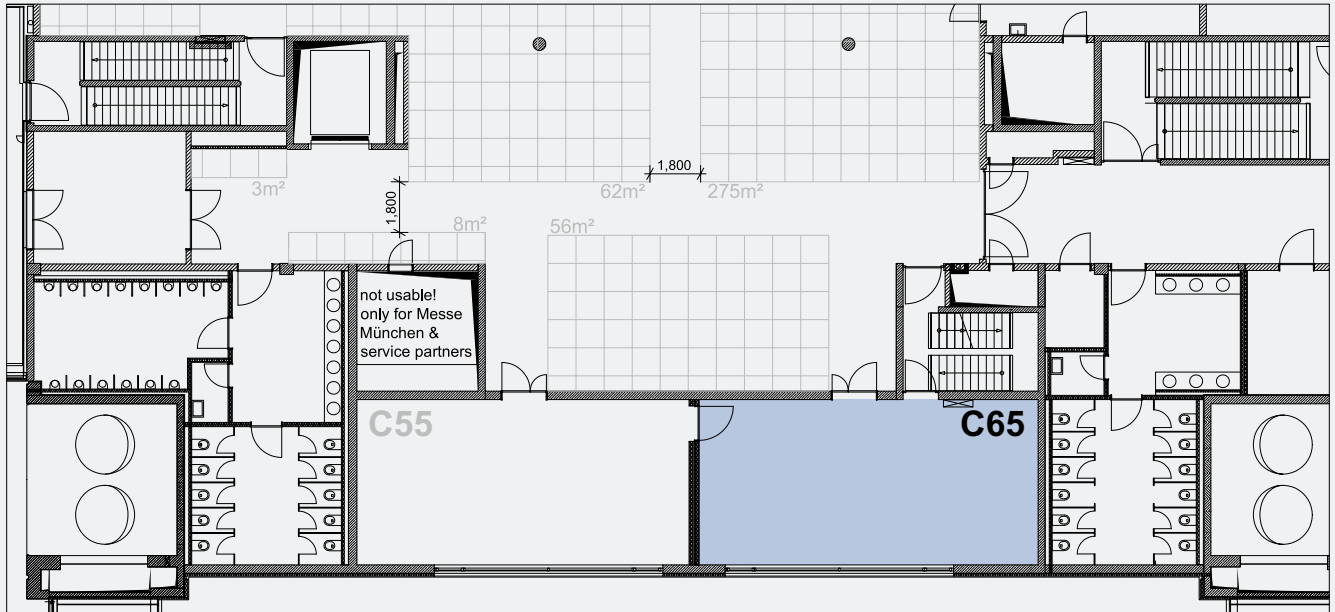

Last update: August 28, 2024  
 Disclosure to third parties only permitted with written authorization. All specifications must be independently verified on location.

### Dimensions in meter

Length 11.82 x Width 5.87

### Area in m<sup>2</sup>

70

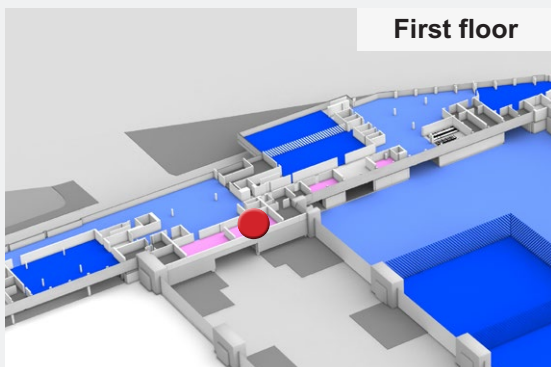

First floor

### Exhibition Terms and Conditions:

- Exhibition layout with sufficient emergency aisles between the hatched areas
- Fire extinguishing equipment and emergency escape routes must be kept clear at all times, even during setup and dismantling
- Dimensions must be independently verified on location

# CCN – Conference Center North Messe München

## CONFERENCE ROOM C65: THEATER SEATING

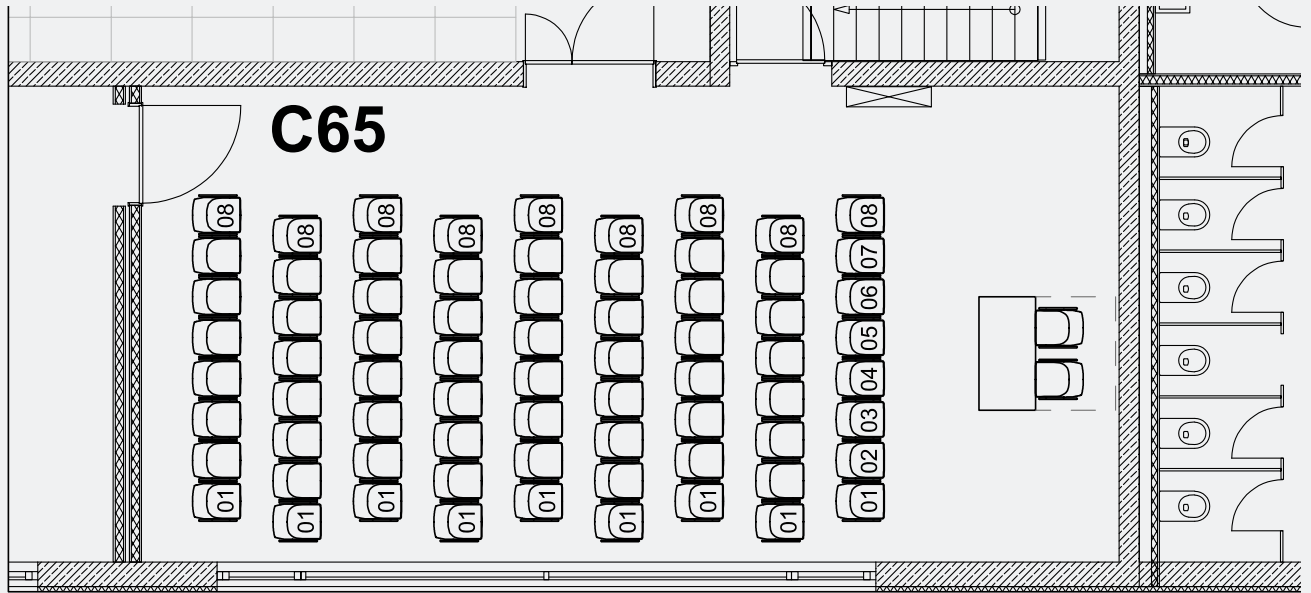

Last update: August 28, 2024  
Disclosure to third parties only permitted with written authorization. All specifications must be independently verified on location.

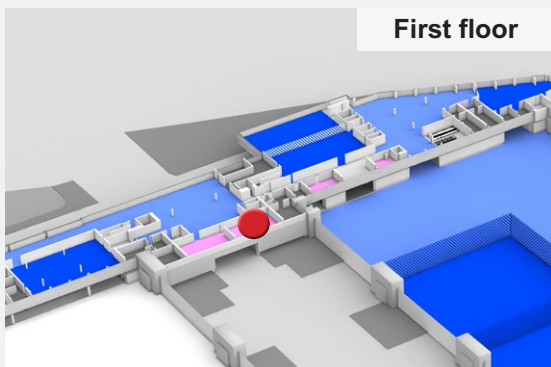



First floor

Dimensions in meter
Length 11.82 x Width 5.87

Area in m <sup>2</sup>
70

Theater
72

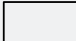
-  Chair
-  Table
-  Chairman's table (140 x 70 cm)

- Exhibition Terms and Conditions:**
- Exhibition layout with sufficient emergency aisles between the hatched areas
  - Fire extinguishing equipment and emergency escape routes must be kept clear at all times, even during setup and dismantling
  - Dimensions must be independently verified on location



# CCN – Conference Center North Messe München

## CONFERENCE ROOM C65: U-SHAPED SEATING

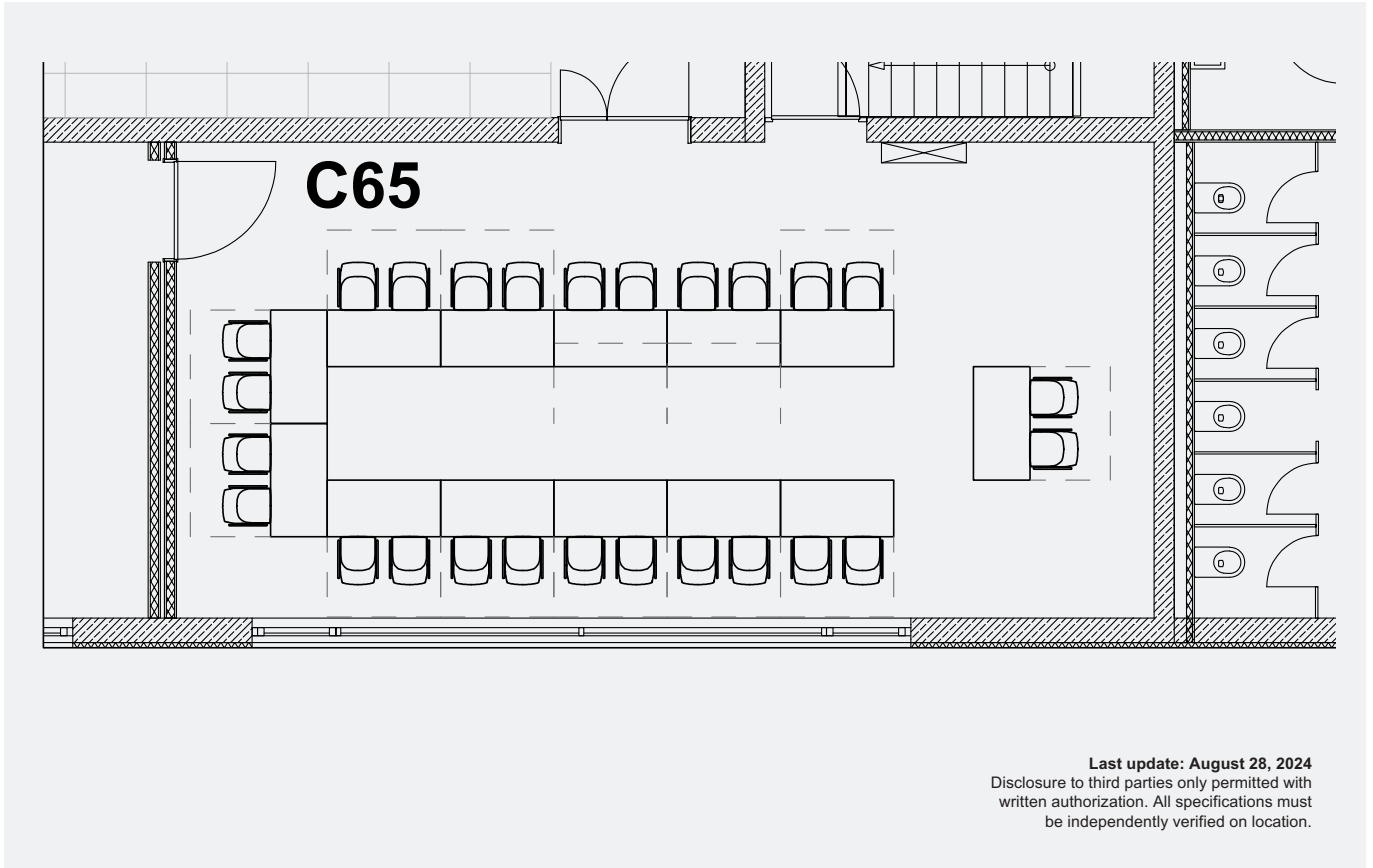

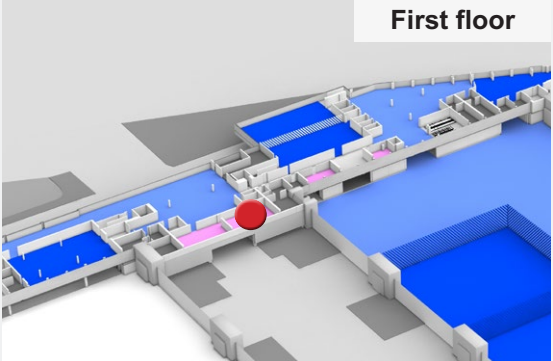

**First floor**

Dimensions in meter	Area in m <sup>2</sup>
Length 11.82 x Width 5.87	70

U-shaped
24

**Chair**

**Table**

**Chairman's table (140 x 70 cm)**

**Exhibition Terms and Conditions:**

- Exhibition layout with sufficient emergency aisles between the hatched areas
- Fire extinguishing equipment and emergency escape routes must be kept clear at all times, even during setup and dismantling
- Dimensions must be independently verified on location

CCN – Conference Center North Messe München  
**CONFERENCE ROOM C65:**  
**BLOCK SEATING**

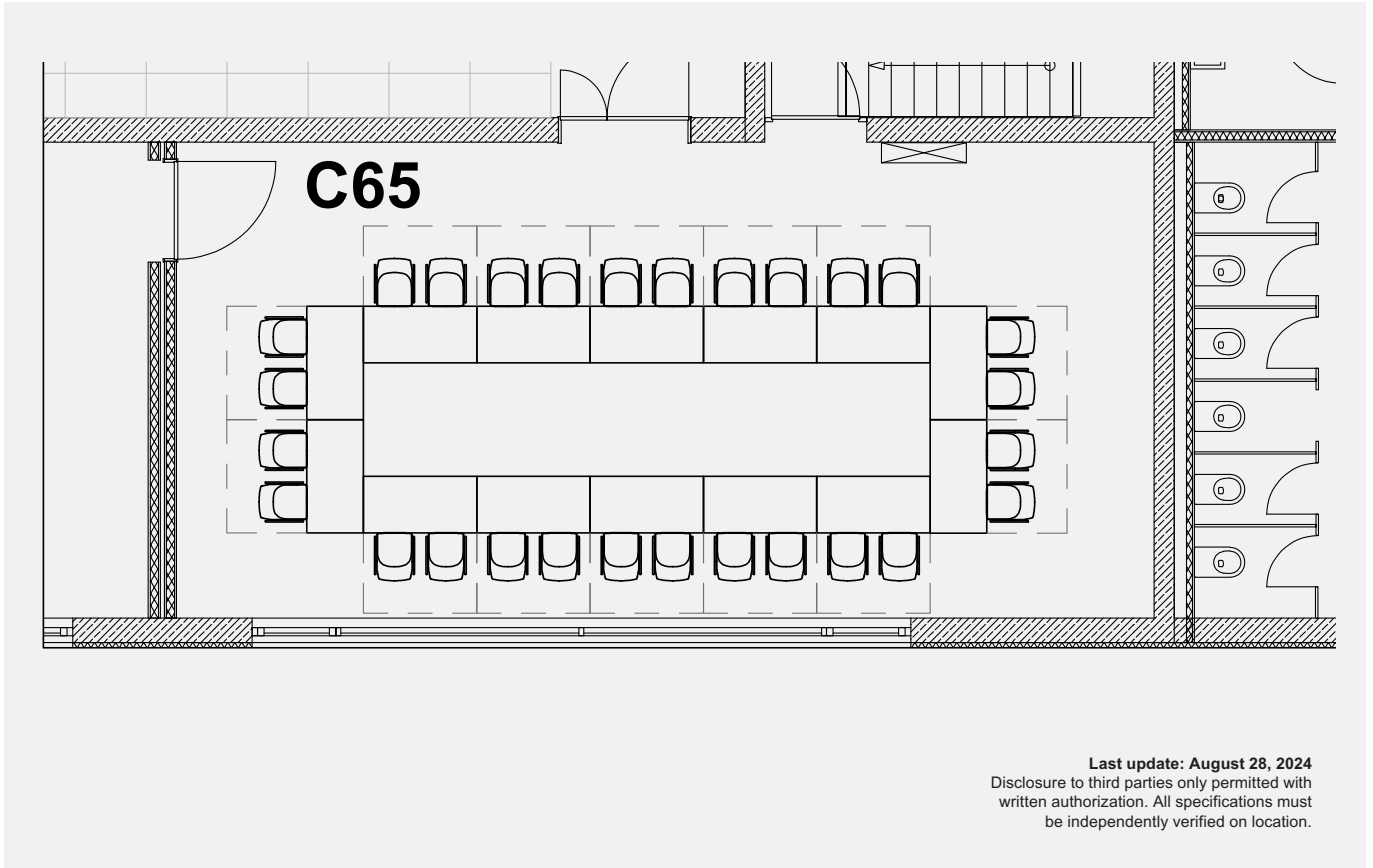

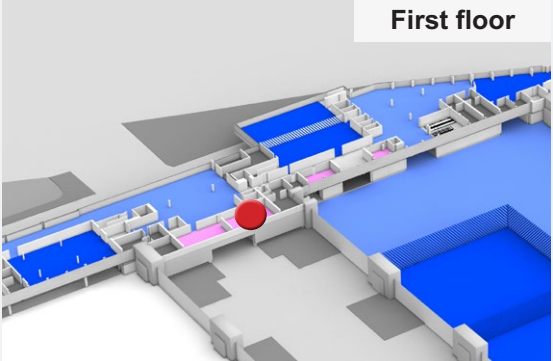

**First floor**

Dimensions in meter	Area in m <sup>2</sup>
Length 11.82 x Width 5.87	70

Block
28

**Chair**

**Table**

**Chairman's table (140 x 70 cm)**

**Exhibition Terms and Conditions:**

- Exhibition layout with sufficient emergency aisles between the hatched areas
- Fire extinguishing equipment and emergency escape routes must be kept clear at all times, even during setup and dismantling
- Dimensions must be independently verified on location