





Areas/ Rooms	Area in m ²	 Theater	 Classroom	 Banquet	 U-shaped	 Block
Room 21	130	125	68	72	32	40
Room 21a	63	60	30	40	16	24
Room 21b	63	60	30	40	16	24

Room 21: Perfect for Events with up to 125 Guests

This room on the second floor is suitable for small lectures, presentations, meetings and workgroup sessions. It has 130 m² of space and can accommodate 125 people in theater seating, 68 people with classroom seating or 72 people with banquet seating. Other seating alternatives are also possible, but require authorization from the fire department. This room can also be partitioned to form two smaller rooms. Standard features include media equipment, lighting and direct media connections to other rooms.

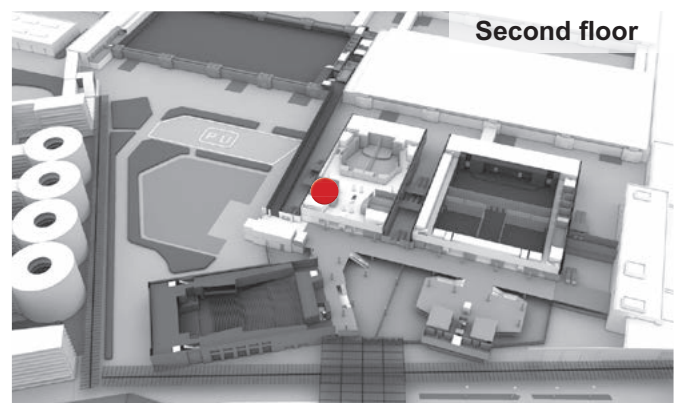

Rooms 21a and 21b: Perfect for Events with up to 60 Guests

These rooms on the second floor are particularly suitable for small meetings and workgroup sessions. They each have 63 m² of space and can accommodate 60 people in theater seating, 30 people with classroom seating or 40 people with banquet seating. Other seating alternatives are also possible but require authorization from the fire department. Standard features include media equipment—some portable, some permanently installed—lighting and direct media connections to other rooms.

Specifications

Location	<ul style="list-style-type: none"> Deliveries via the north delivery entrance on the ground floor of the foyer Deliveries also via the elevator next to Room 1 or the elevators next to Room 5 (2 m wide, 3 m long, max. 2,000 kg)
Suitable for	<ul style="list-style-type: none"> Room 21: Smaller lectures, presentations, meetings, group work, etc. Rooms 21a and 21b: Smaller working groups and workshops
Size/capacity	<ul style="list-style-type: none"> Room 21: 130 m²; seats 125 people in theater seating, 68 people with classroom seating, 72 people with banquet seating Rooms 21a and 21b: 63 m² each; seats 60 people in theater seating, 30 people with classroom seating, 40 people with banquet seating Other seating arrangements are possible with the authorization of the fire department.

ICM – International Congress Center Messe München

DETAILS ROOM 21

Specifications

Special features	<ul style="list-style-type: none">■ Daylight—but can also be darkened.■ Room 21: Can be partitioned into Rooms 21a and 21b, see detailed description.■ Rooms 21, 21a and 21b do not have a control booth. Any necessary additional equipment is set up directly in the room.■ Permissible floor load: 500 kg/m² (5 kN/m²)
Screen	<ul style="list-style-type: none">■ The room is equipped with a permanently installed screen for front projection with a visible projection area of 5.40 m x 2.20 m (w x h). The screen is rolled up onto a drum and can be lowered when needed. Other portable screens for front and rear projection are also available.
Media equipment	<p>Room 21 is equipped with two digital 16-channel mixing consoles, one laser projector and a sound system.</p> <ul style="list-style-type: none">■ 2 x CD, SD, CF, USB player/recorder■ 2 x 2-channel UHF microphone system■ Additional media technology can be installed in partitioned rooms.■ Audio and video cross-connections into other halls and rooms possible
Lighting	<ul style="list-style-type: none">■ The room has permanently installed dimmable downlights at a height of 2.95 m.■ They are controlled from a console in the room.

ICM – International Congress Center Messe München
ROOM 21: EMPTY

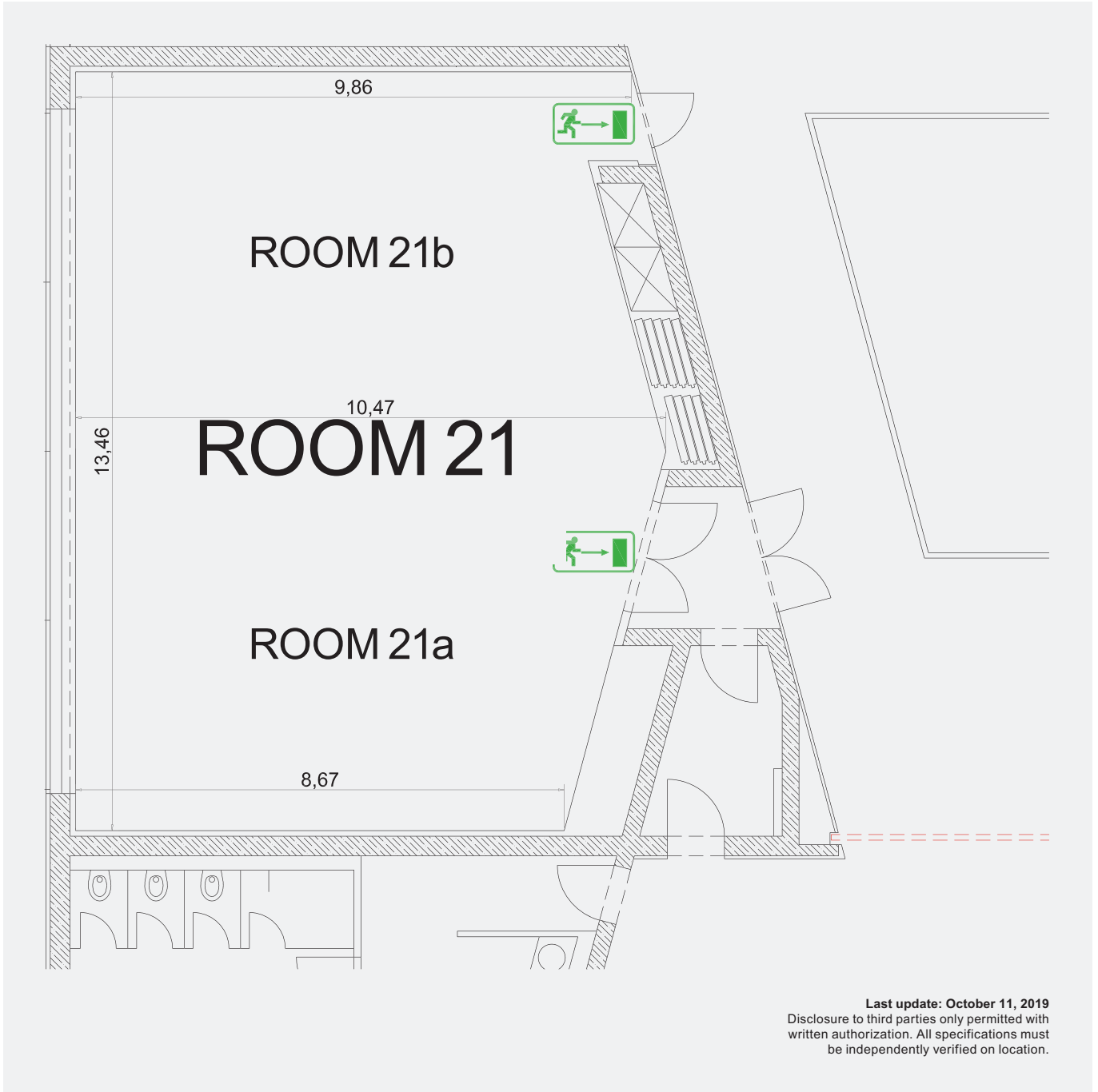

Last update: October 11, 2019
 Disclosure to third parties only permitted with written authorization. All specifications must be independently verified on location.

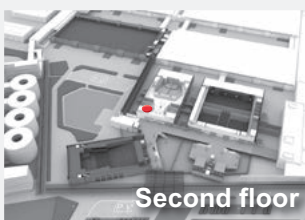

 Escape route

Room 21
130 m ²

Room 21a and 21b
63 m ² each

ICM – International Congress Center Messe München

ROOM 21: THEATER SEATING

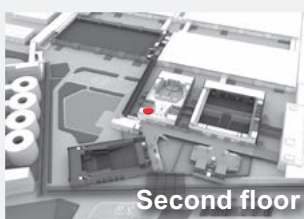
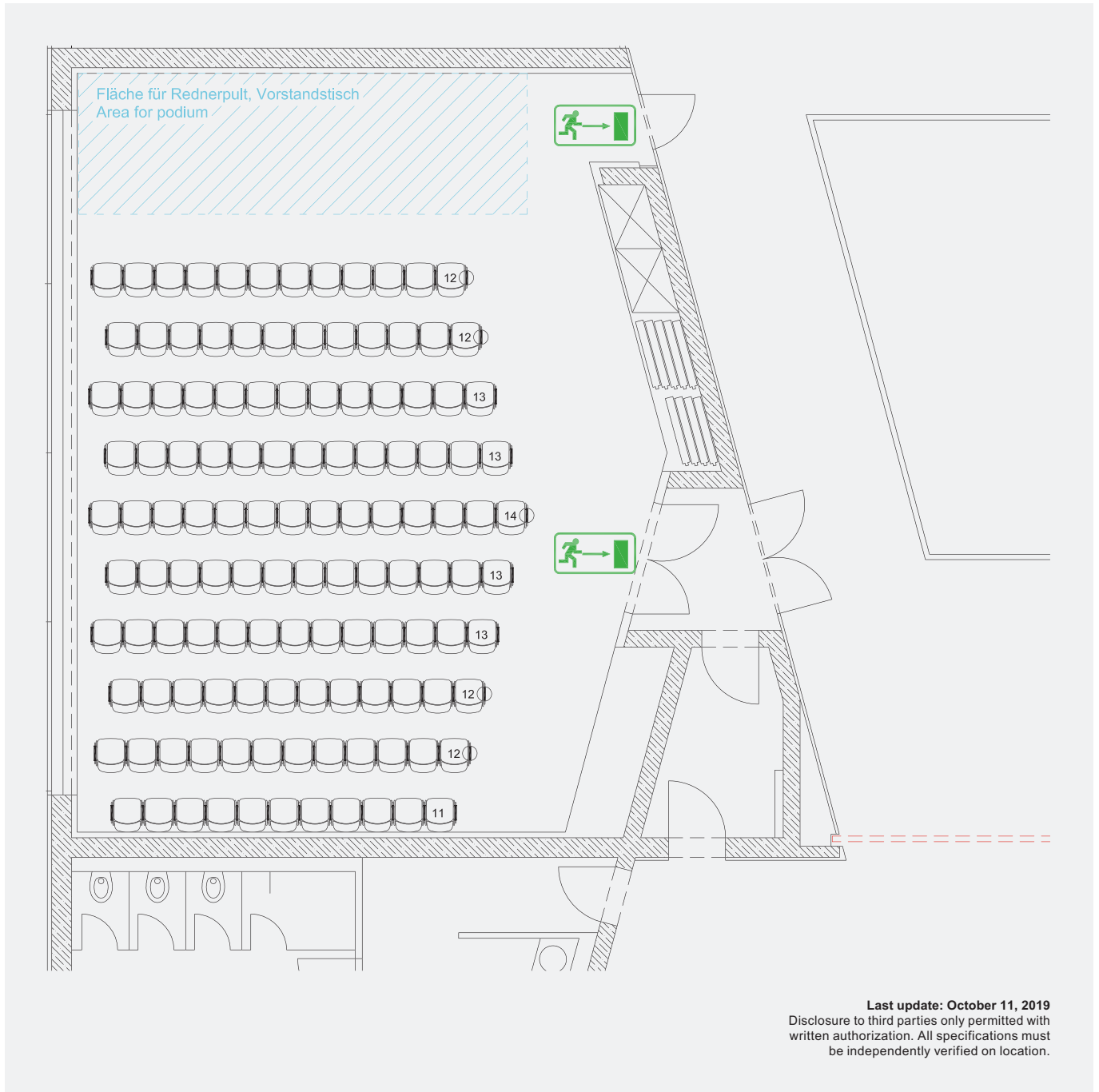

 Escape route

Area in m²
130

 Theater
125

ICM – International Congress Center Messe München

ROOM 21: CLASSROOM SEATING

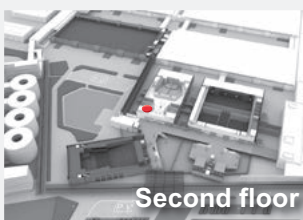
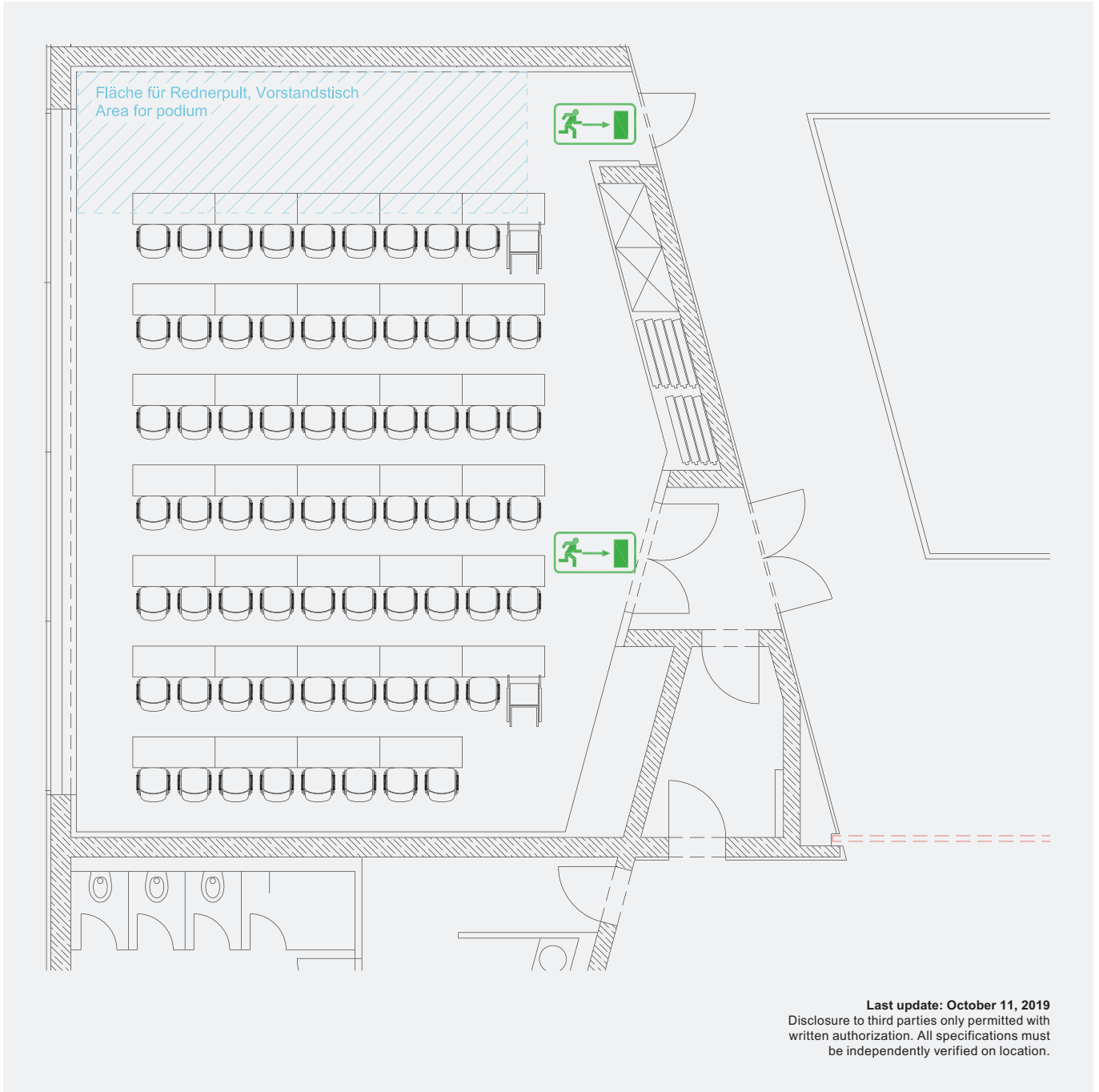

 Escape route

Area in m²

130

 Classroom

68

ICM – International Congress Center Messe München

ROOM 21: BANQUET SEATING

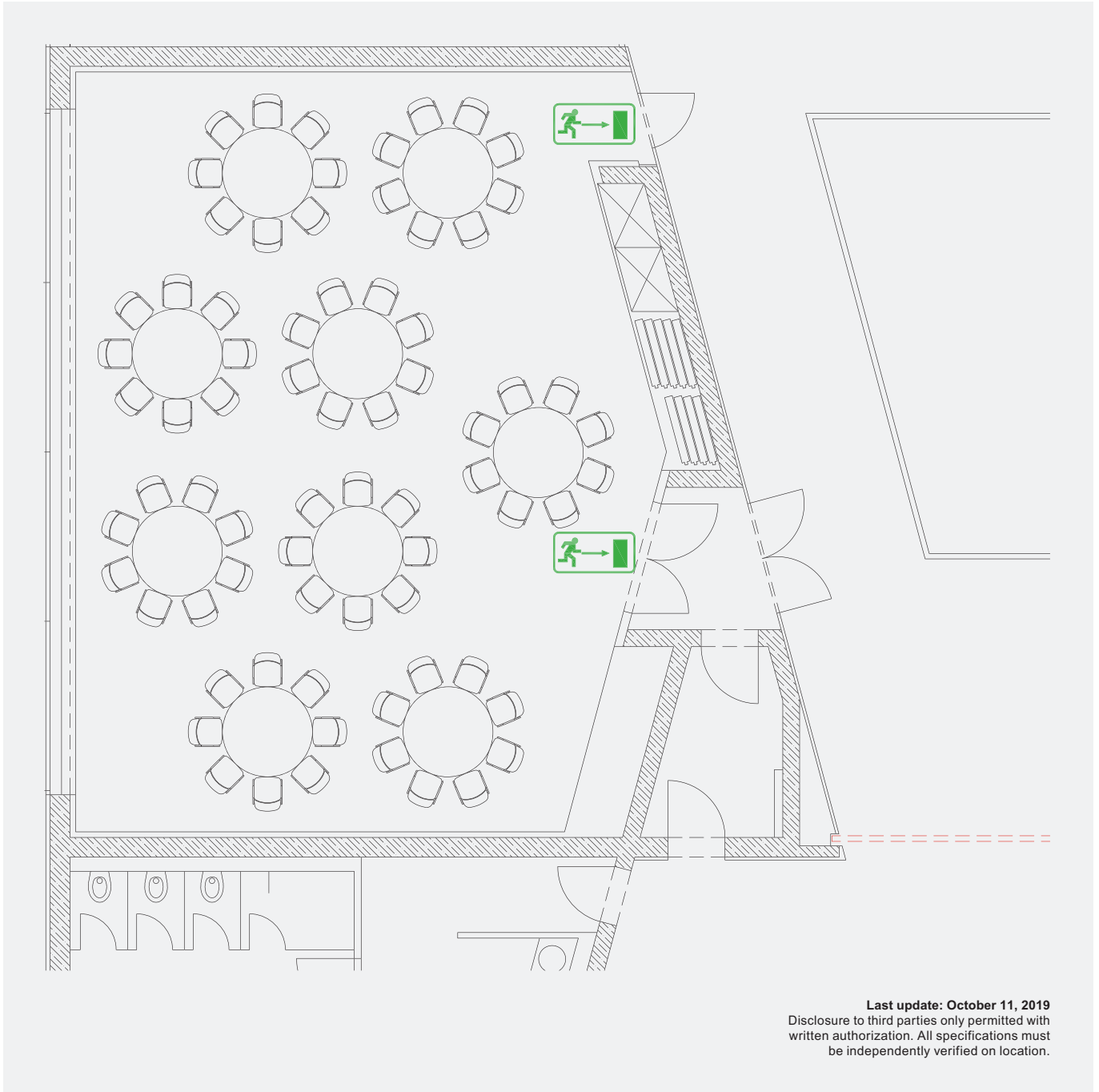

Last update: October 11, 2019
Disclosure to third parties only permitted with written authorization. All specifications must be independently verified on location.

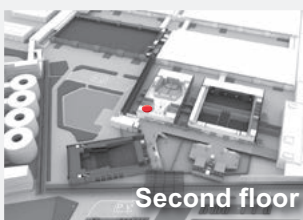

 Escape route

Area in m²

130

 Banquet

72

ICM – International Congress Center Messe München

ROOM 21: U-SHAPED SEATING

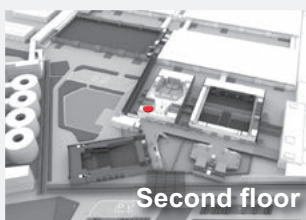
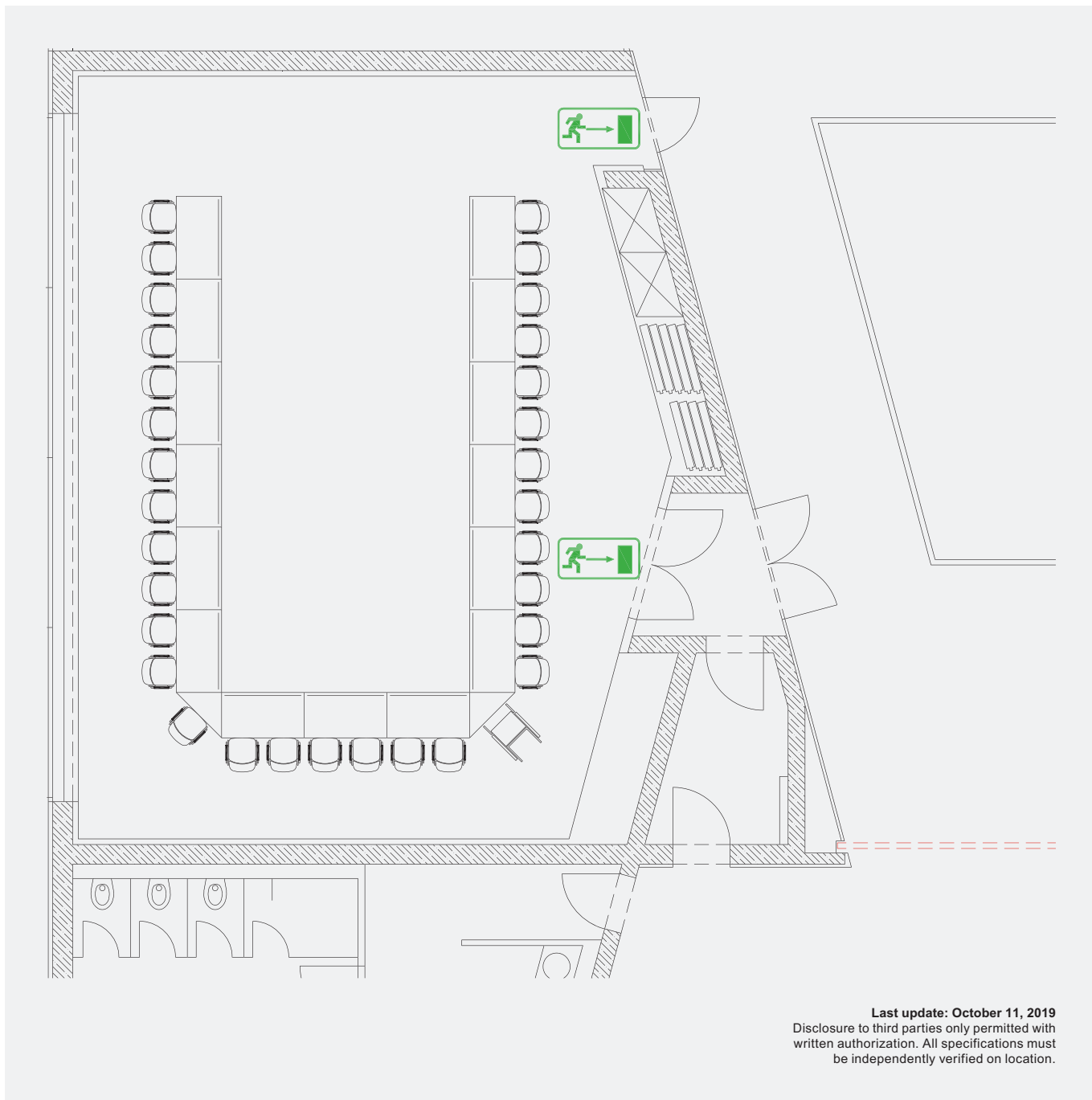

 Escape route

Area in m²

130

 U-shaped

32

ICM – International Congress Center Messe München

ROOM 21: BLOCK SEATING

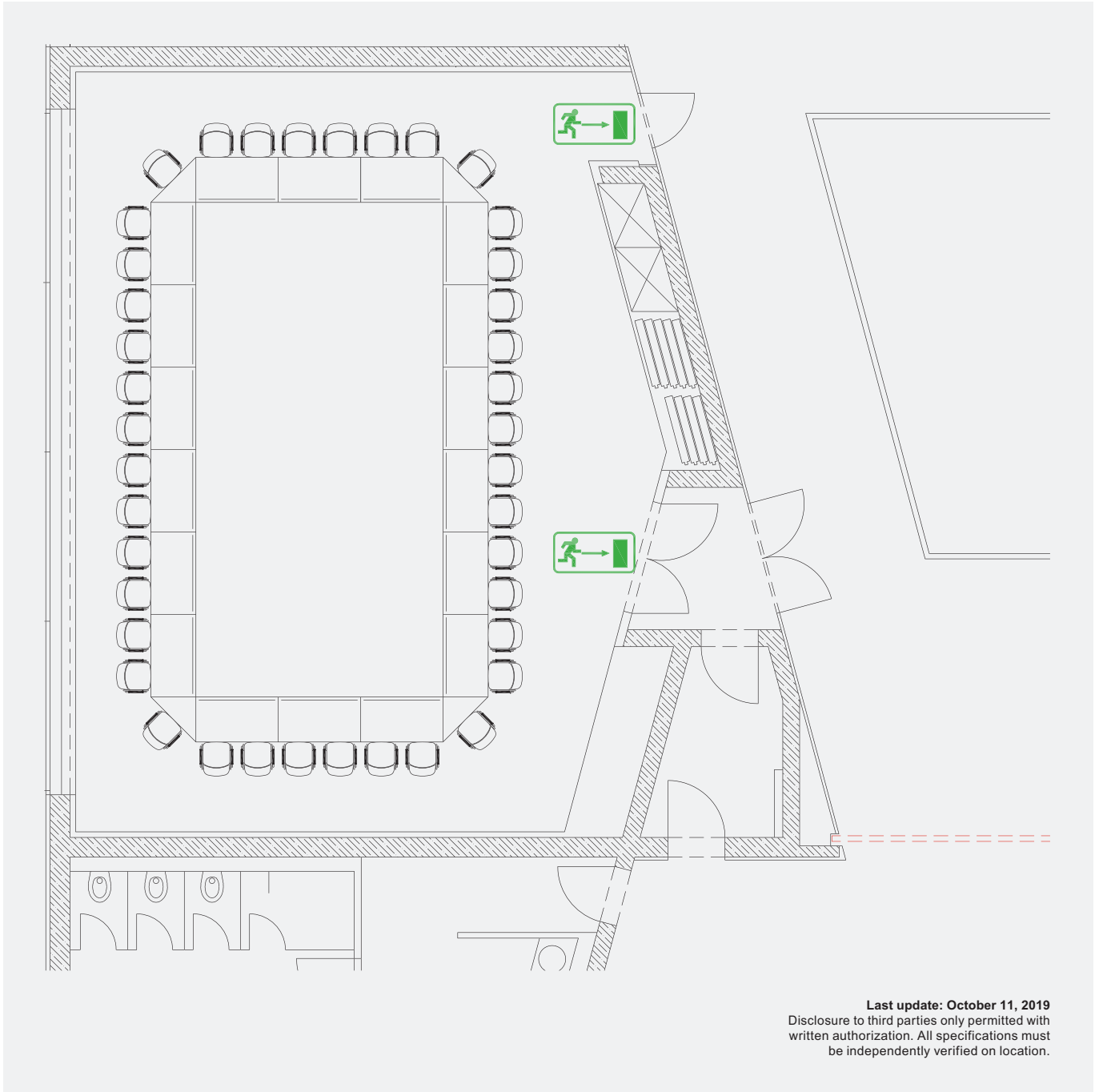

Last update: October 11, 2019
Disclosure to third parties only permitted with written authorization. All specifications must be independently verified on location.

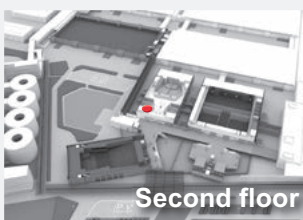

 Escape route

Area in m²

130

 Block

40

ICM – International Congress Center Messe München

ROOM 21a: EMPTY

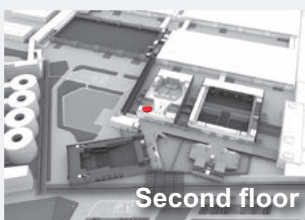
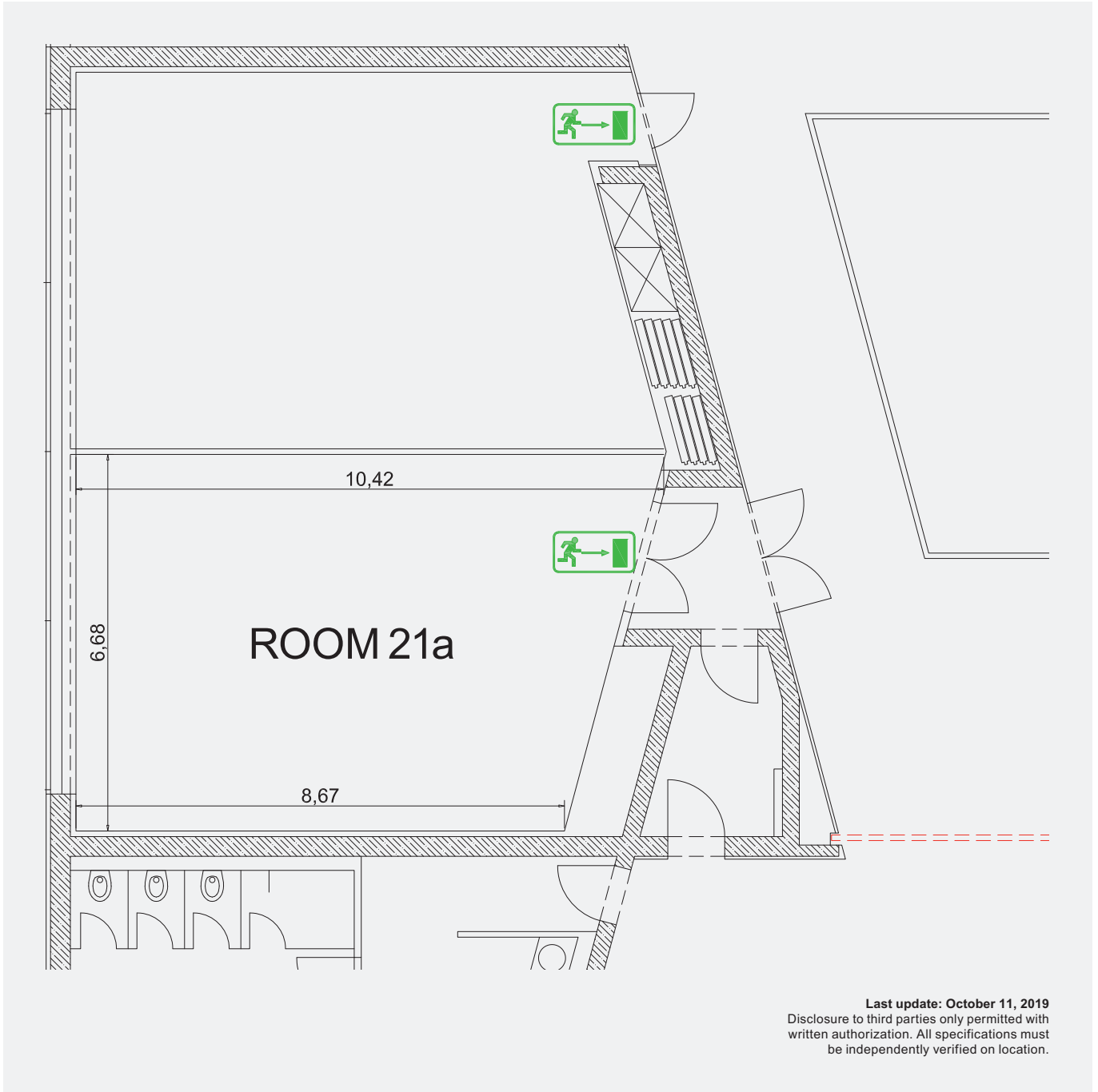

 Escape route

Area in m²

63

ICM – International Congress Center Messe München

ROOM 21a: THEATER SEATING

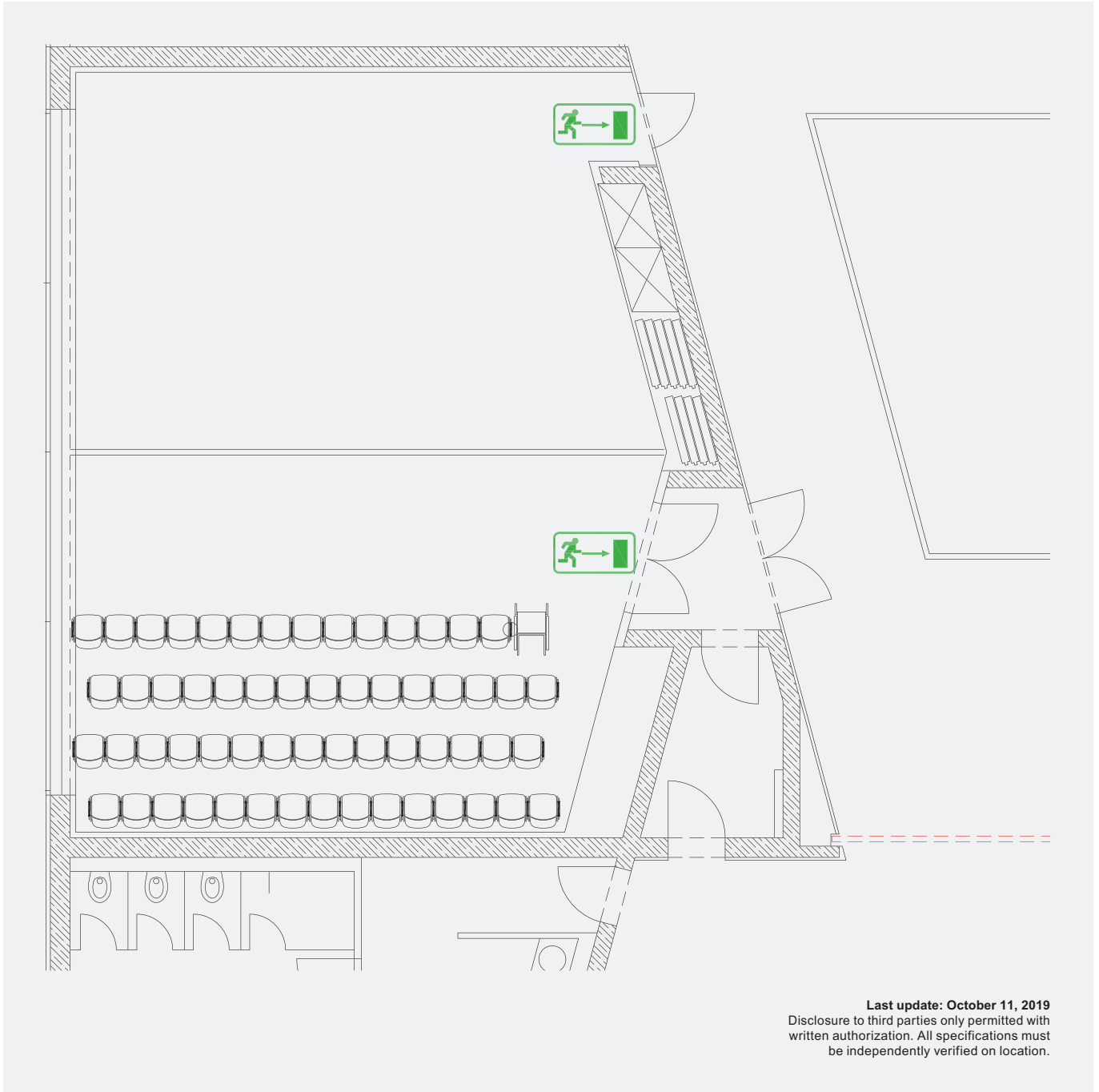

Last update: October 11, 2019
Disclosure to third parties only permitted with written authorization. All specifications must be independently verified on location.

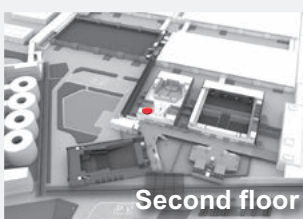

 Escape route

Area in m²

63



Theater

60

ICM – International Congress Center Messe München

ROOM 21a: CLASSROOM SEATING

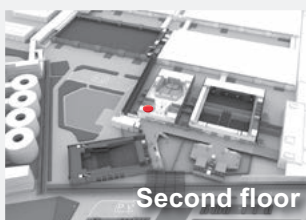
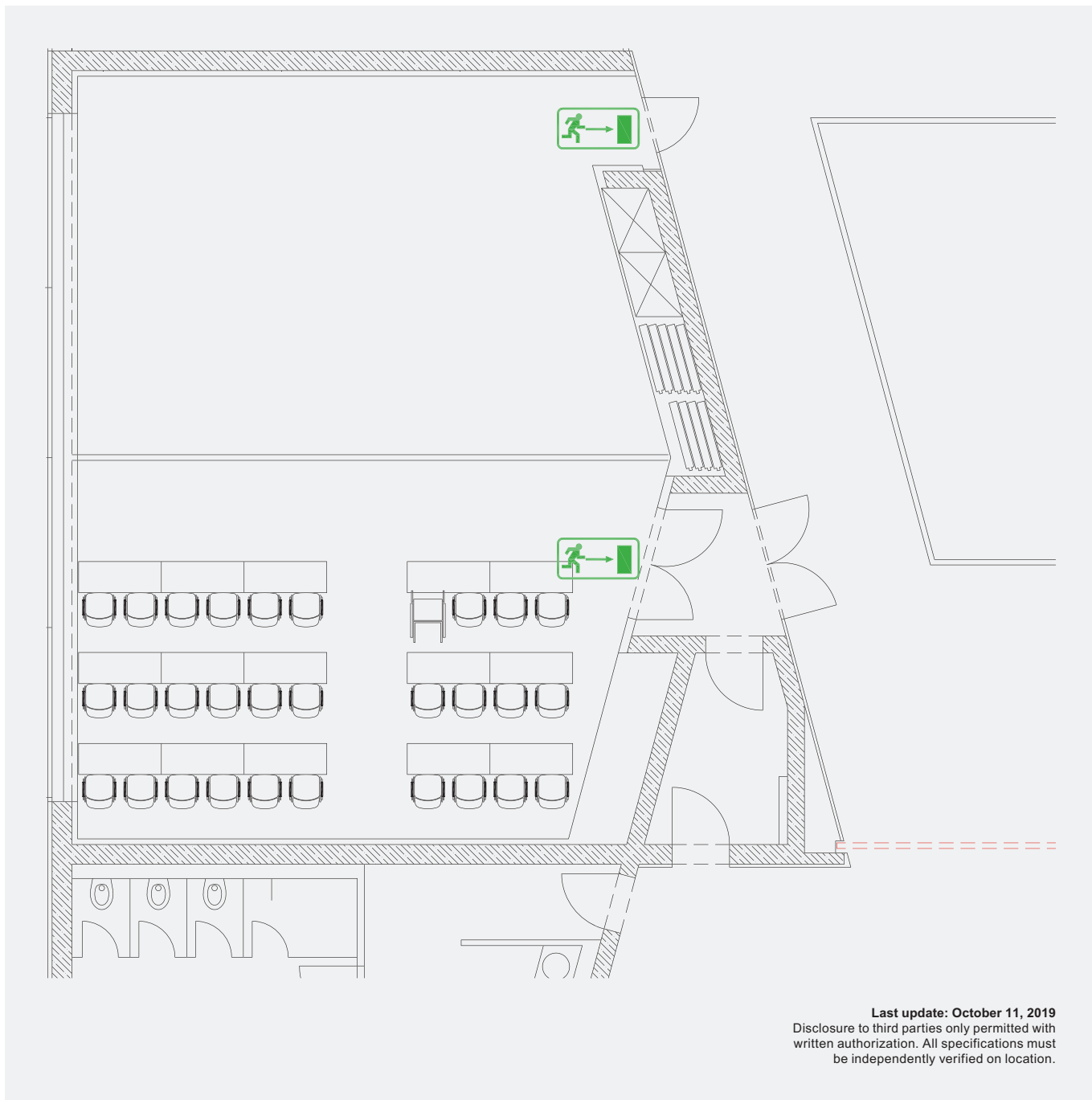

 Escape route

Area in m²

63



Classroom

30

ICM – International Congress Center Messe München

ROOM 21a: BANQUET SEATING

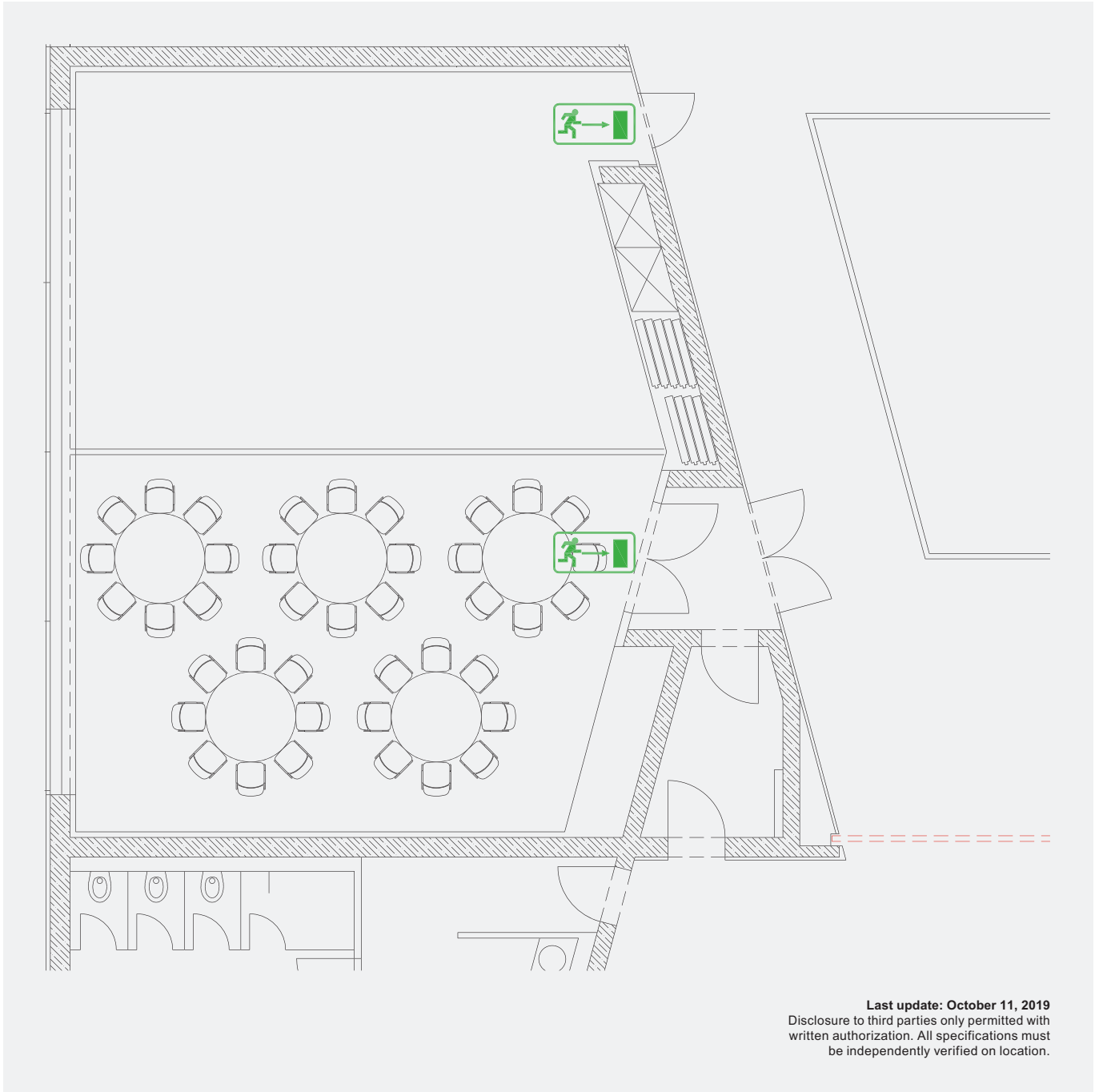

Last update: October 11, 2019
Disclosure to third parties only permitted with written authorization. All specifications must be independently verified on location.

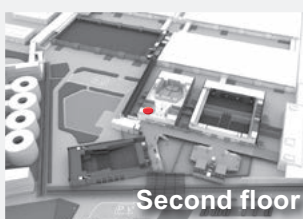

 Escape route

Area in m²

63

 Banquet



40

ICM – International Congress Center Messe München

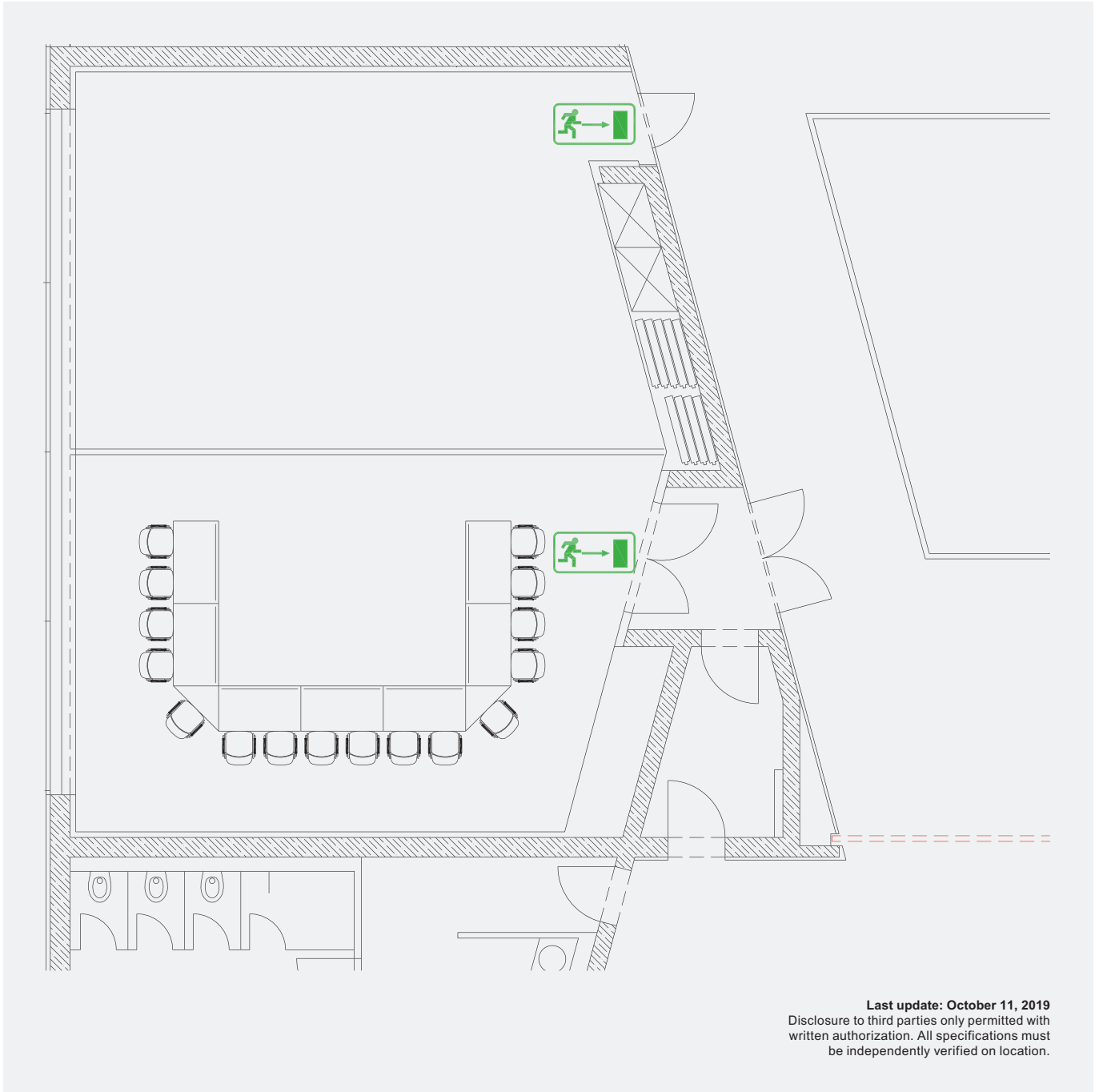
ROOM 21a: U-SHAPED SEATING

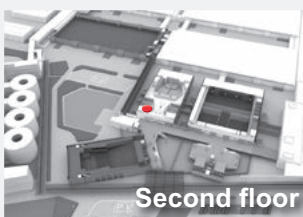

Last update: October 11, 2019
Disclosure to third parties only permitted with written authorization. All specifications must be independently verified on location.

Escape route

Area in m²

63



U-shaped

16

ICM – International Congress Center Messe München

ROOM 21a: BLOCK SEATING

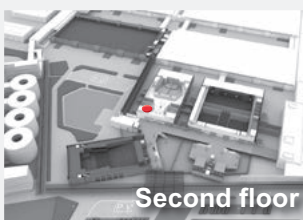
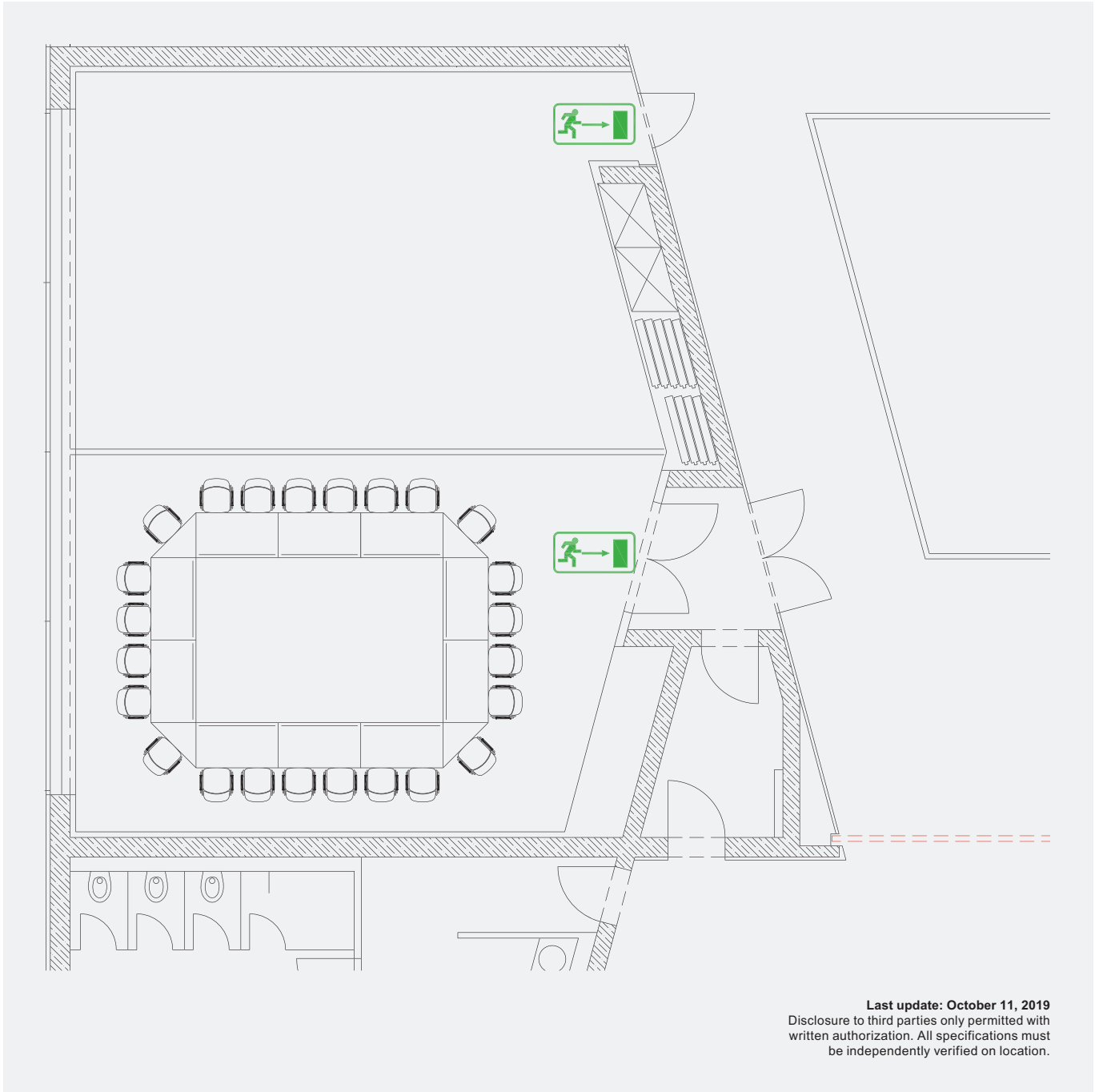

 Escape route

Area in m²

63

 Block

24

ICM – International Congress Center Messe München

ROOM 21b: EMPTY

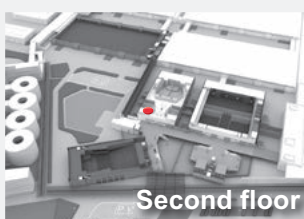
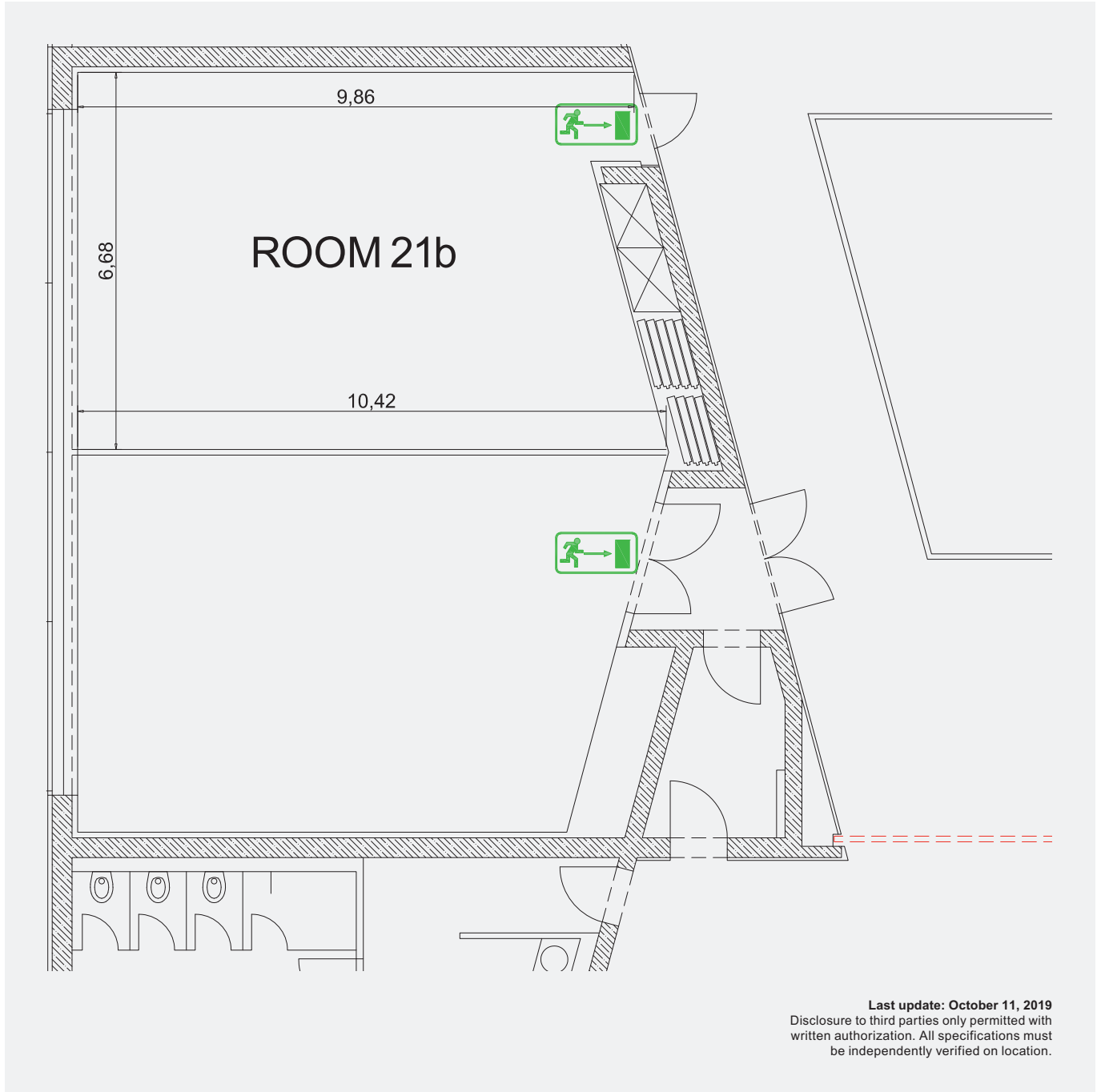

 Escape route

Area in m²

63

ICM – International Congress Center Messe München

ROOM 21b: THEATER SEATING

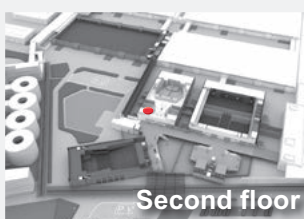
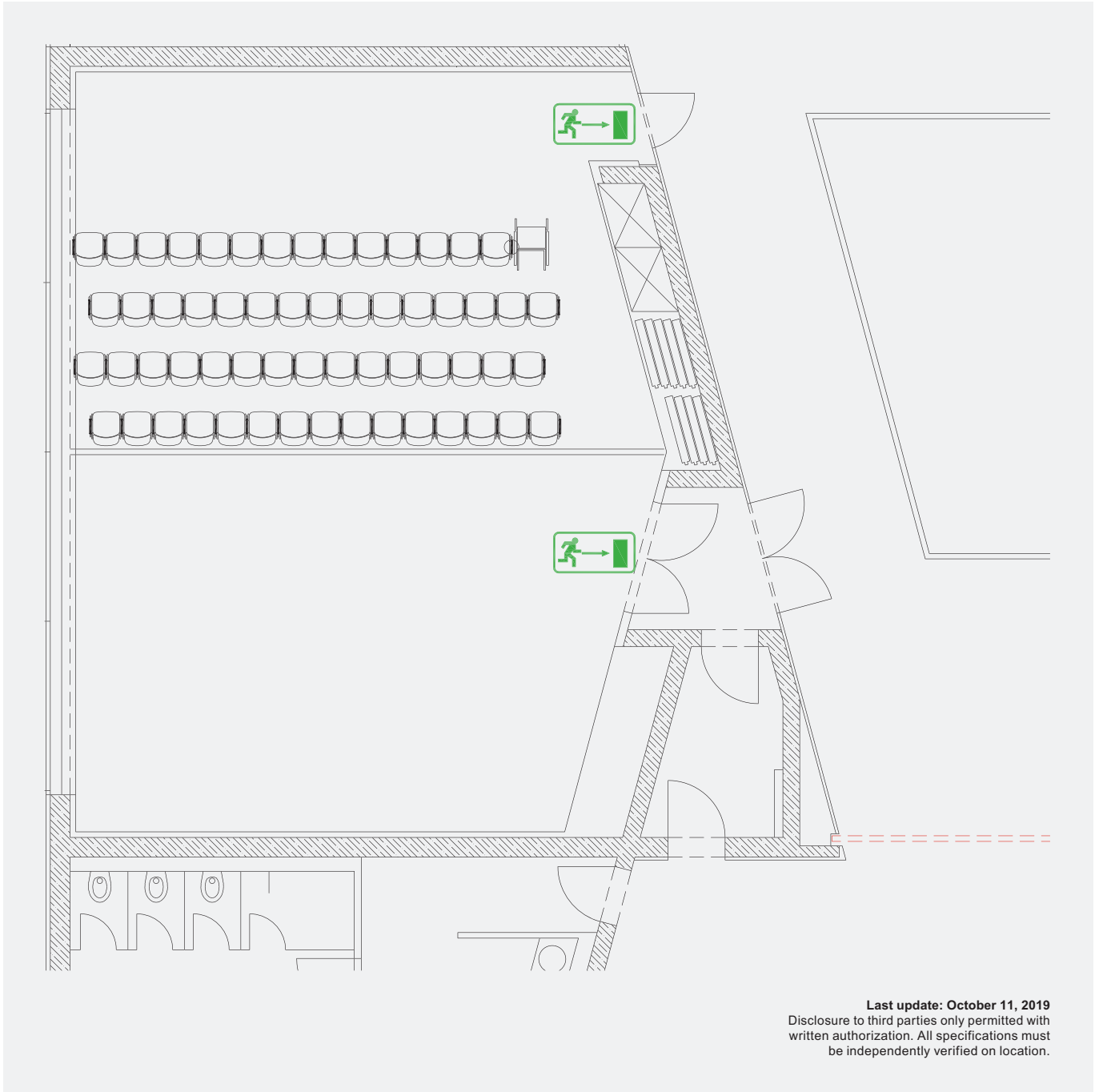

 Escape route

Area in m²

63





Theater

60

ICM – International Congress Center Messe München

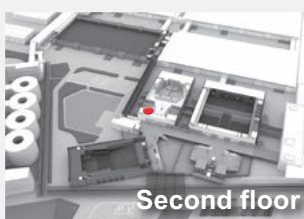
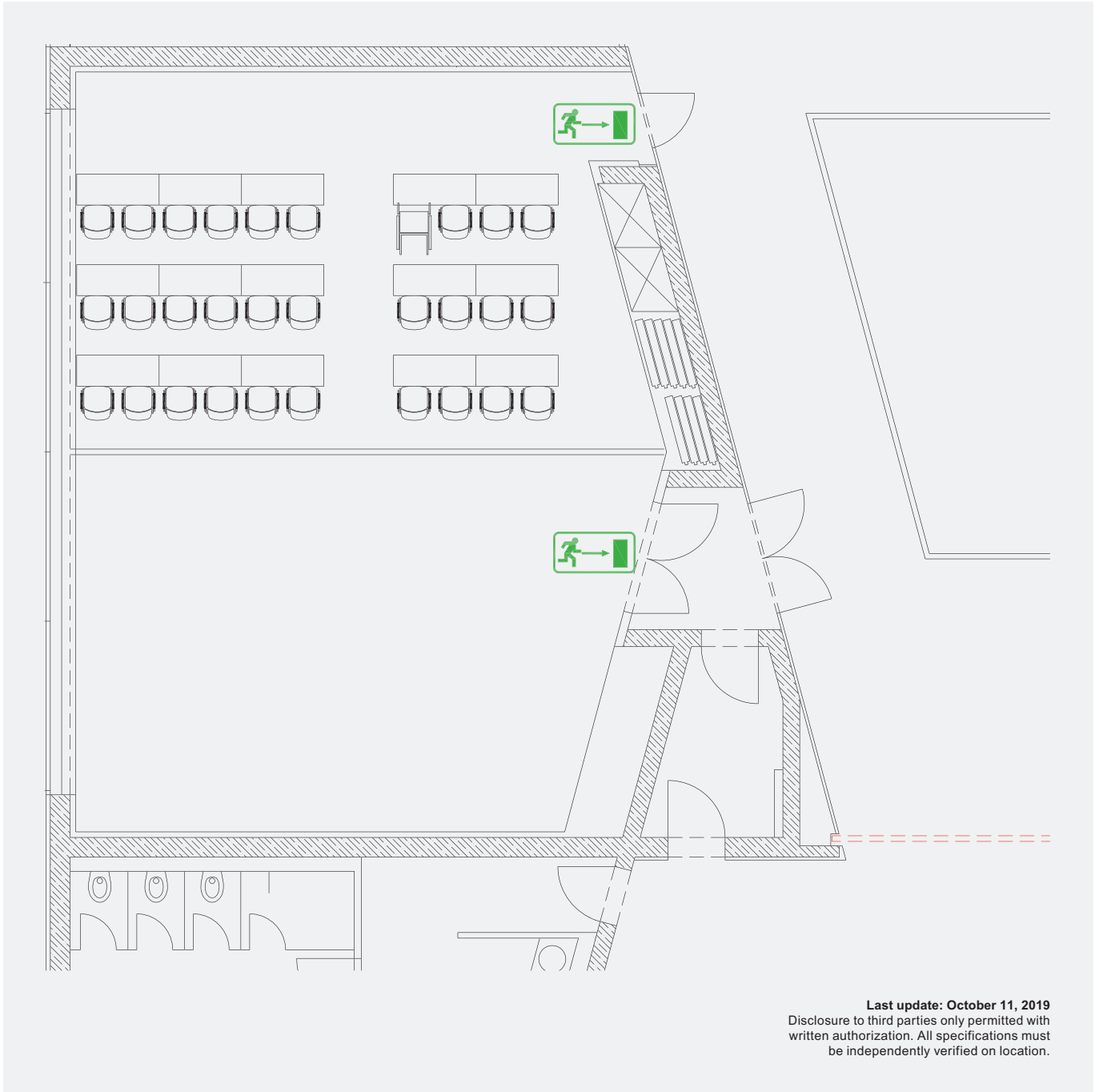
ROOM 21b: CLASSROOM SEATING



 Escape route

Area in m²
63

 Classroom
30

ICM – International Congress Center Messe München

ROOM 21b: BANQUET SEATING

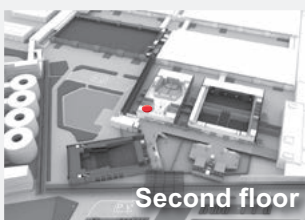
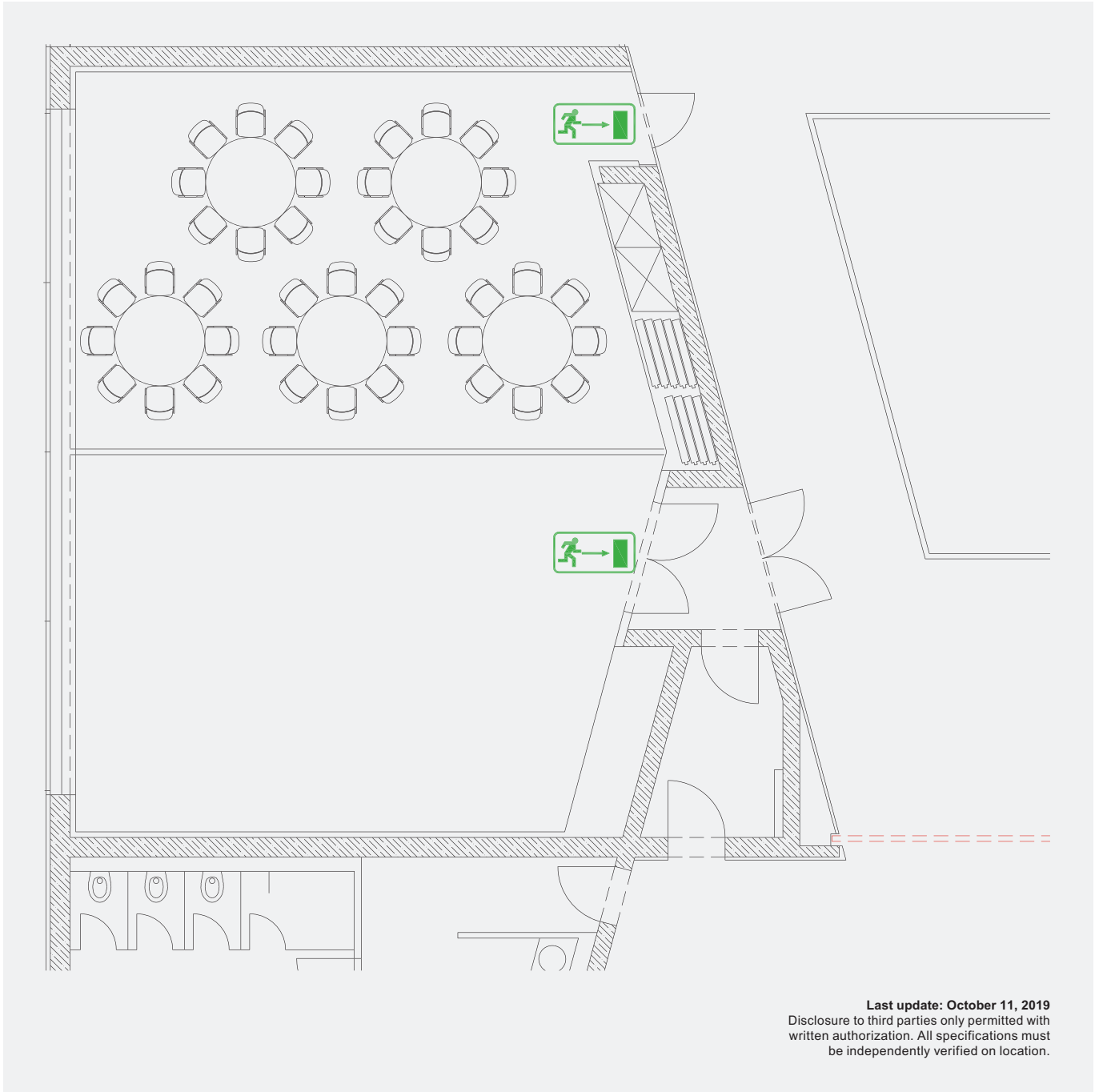

 Escape route

Area in m²

63

 Banquet

40

ICM – International Congress Center Messe München

ROOM 21b: U-SHAPED SEATING

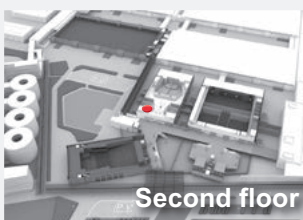
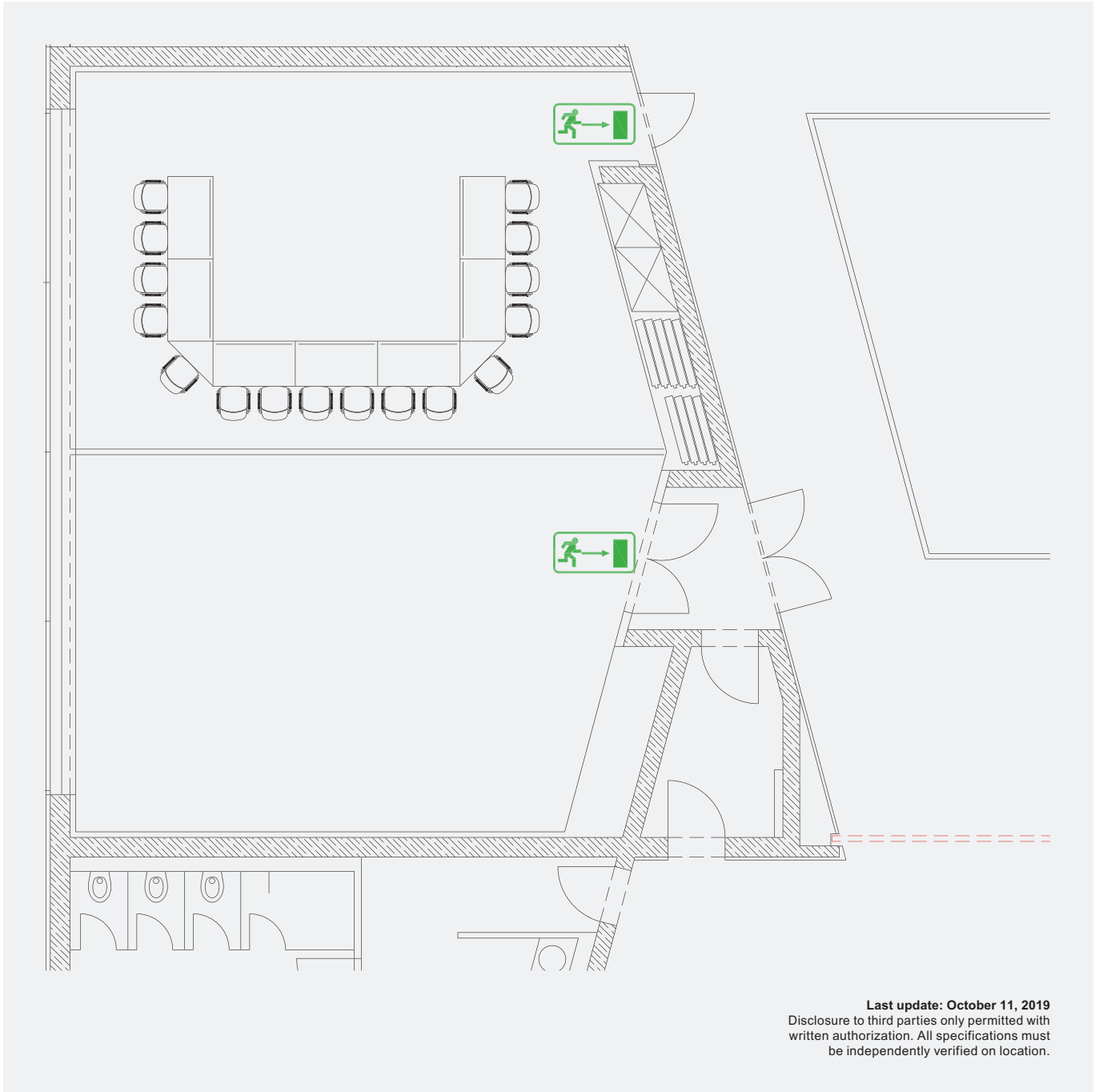

 Escape route

Area in m²

63

 U-shaped

16

ICM – International Congress Center Messe München

ROOM 21b: BLOCK SEATING

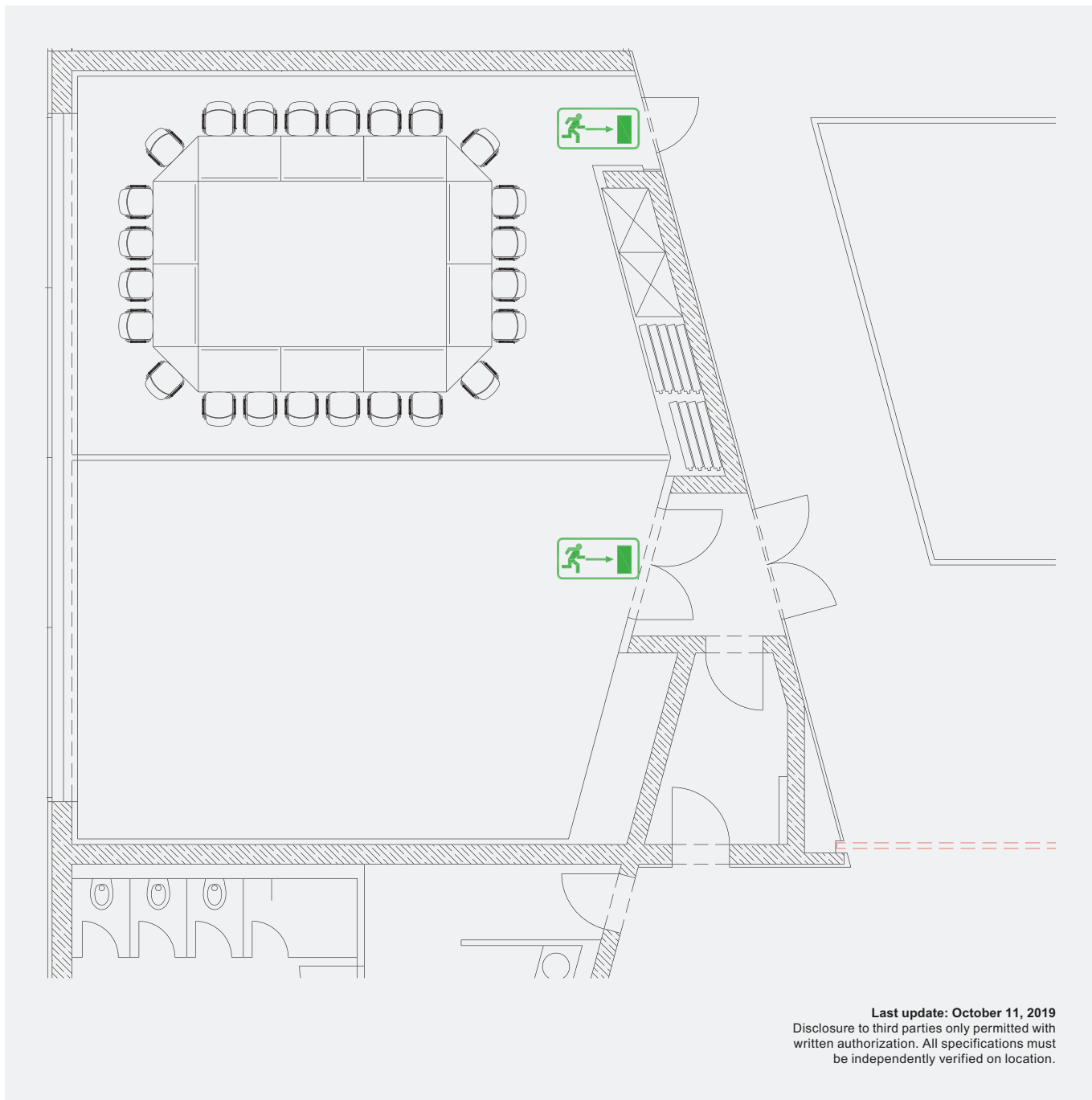

Last update: October 11, 2019
Disclosure to third parties only permitted with written authorization. All specifications must be independently verified on location.

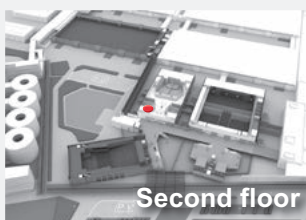

 Escape route

Area in m²

63

 Block

24