





Areas/ rooms	Area in m ²	 Theater	 Classroom	 Banquet	 U-shaped	 Block
Room 12	130	125	68	72	32	40
Room 12a	63	60	30	40	16	24
Room 12b	63	60	30	40	16	24

Room 12: Perfect for Events with up to 125 Guests

This room on the first floor is suitable for small lectures, presentations, meetings and workgroup sessions. It has 130 m² of space and can accommodate 125 people in theater seating, 68 people with classroom seating or 72 people with banquet seating. Other seating alternatives are also possible, but require authorization from the fire department. This room can also be partitioned to form two smaller rooms. Standard features include media equipment, lighting and direct media connections to other rooms.

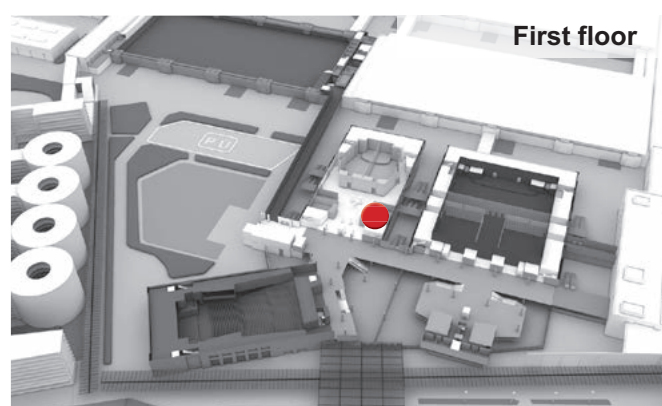

Rooms 12a and 12b: Perfect for Events with up to 60 Guests

With 63 m² of space and seating for 60 people in theater seating, 30 people with classroom seating or 40 people with banquet seating, Rooms 12a and 12b can be used for smaller-scale events such as workgroup sessions and training courses. They feature permanently installed media equipment, but a portable interpreter's booth can be set up, and direct media connections to other rooms are also possible.

Specifications

Location	<ul style="list-style-type: none"> Deliveries via the north delivery door on the ground floor of the foyer Deliveries may also be made via the elevator next to Room 1 or the elevators next to Room 5 (2 m wide, 3 m long, max. 2,000 kg).
Suitable for	<ul style="list-style-type: none"> Room 12: Smaller lectures, presentations, meetings, group work, etc. Rooms 12a and 12b: Small workgroups and workshops
Size/capacity	<ul style="list-style-type: none"> Room 12: 130 m², seating for 125 people in theater seating, 68 people with classroom seating, 72 people with banquet seating Rooms 12a and 12b: 63 m² each; Seating for 60 people in theater seating, 30 people with classroom seating, 40 people with banquet seating Other seating arrangements possible with the authorization of the fire department

Specifications

Special features	<ul style="list-style-type: none">■ Daylight—but can also be darkened.■ Can be partitioned into Rooms 12a and 12b, see detailed description.■ Rooms 12, 12a and 12b have no control booth. Any necessary additional equipment is set up directly in the room.■ Permissible floor load: 500 kg/m² (5 kN/m²)
Screens	<ul style="list-style-type: none">■ Room 12 resp. partitioned Room 12b is equipped with a permanently installed front-projection screen with a visible projection area of 5.30 m x 2.90 m (w x h). The screen in partitioned Room 12a is 3.40 m x 2.90 m (w x h). The screens are rolled up on drums and can be lowered when needed. Other portable screens for front and rear projection are also available
Media equipment	<p>Room 12 is equipped with two digital 16-channel mixing consoles, one laser projector and a sound system.</p> <ul style="list-style-type: none">■ 2 x CD, SD, CF, USB player/recorder■ 2 x 2-channel UHF microphone system■ Additional media technology can be installed in partitioned rooms.■ Audio and video cross-connections into other halls and rooms possible
Lighting	<ul style="list-style-type: none">■ All rooms have permanently installed dimmable downlights at a height of 2.95 m.■ They are controlled from a console in the room.

ICM – International Congress Center Messe München

ROOM 12: EMPTY

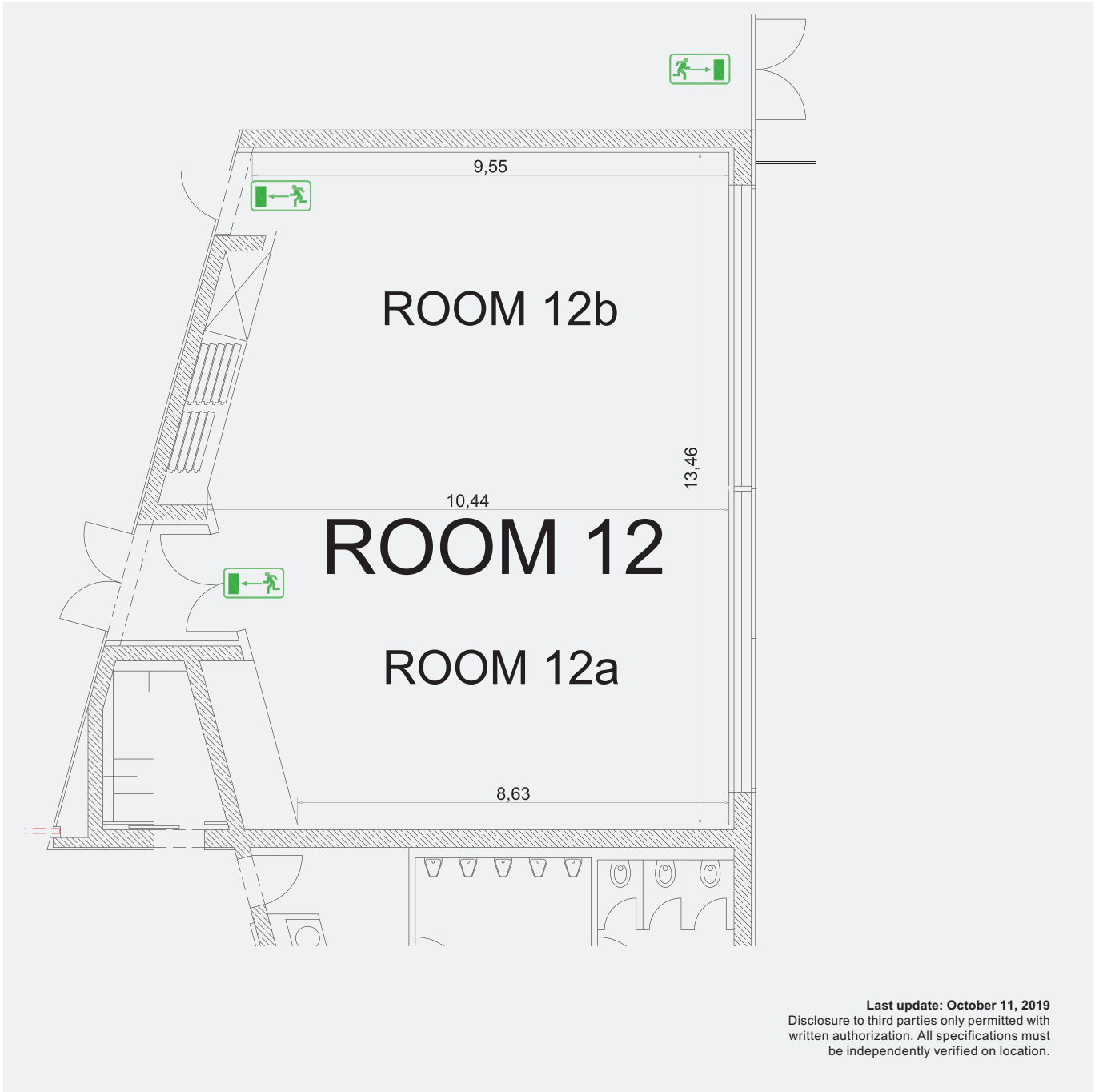

Last update: October 11, 2019
Disclosure to third parties only permitted with written authorization. All specifications must be independently verified on location.

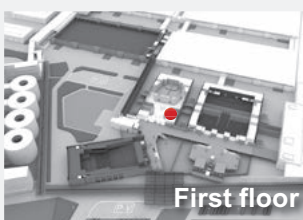

 Escape route

Room 12

130 m²

Room 12a and 12b

63 m² each

ICM – International Congress Center Messe München

ROOM 12: THEATER SEATING

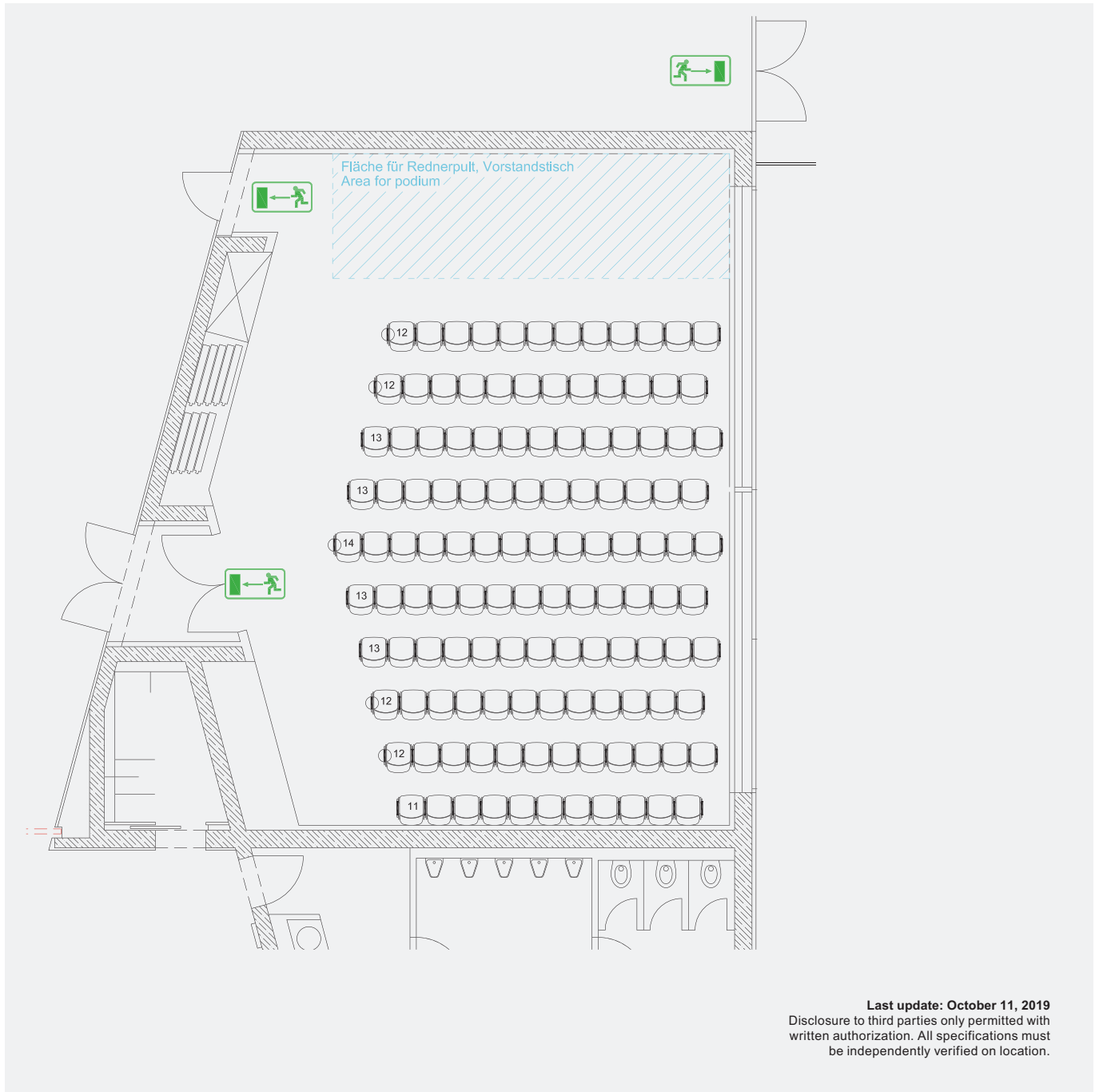

Last update: October 11, 2019
Disclosure to third parties only permitted with written authorization. All specifications must be independently verified on location.

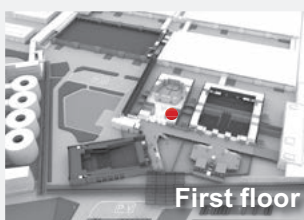

 Escape route

Area in m ²
130

 Theater
125

ICM – International Congress Center Messe München

ROOM 12: CLASSROOM SEATING

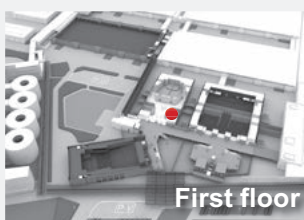
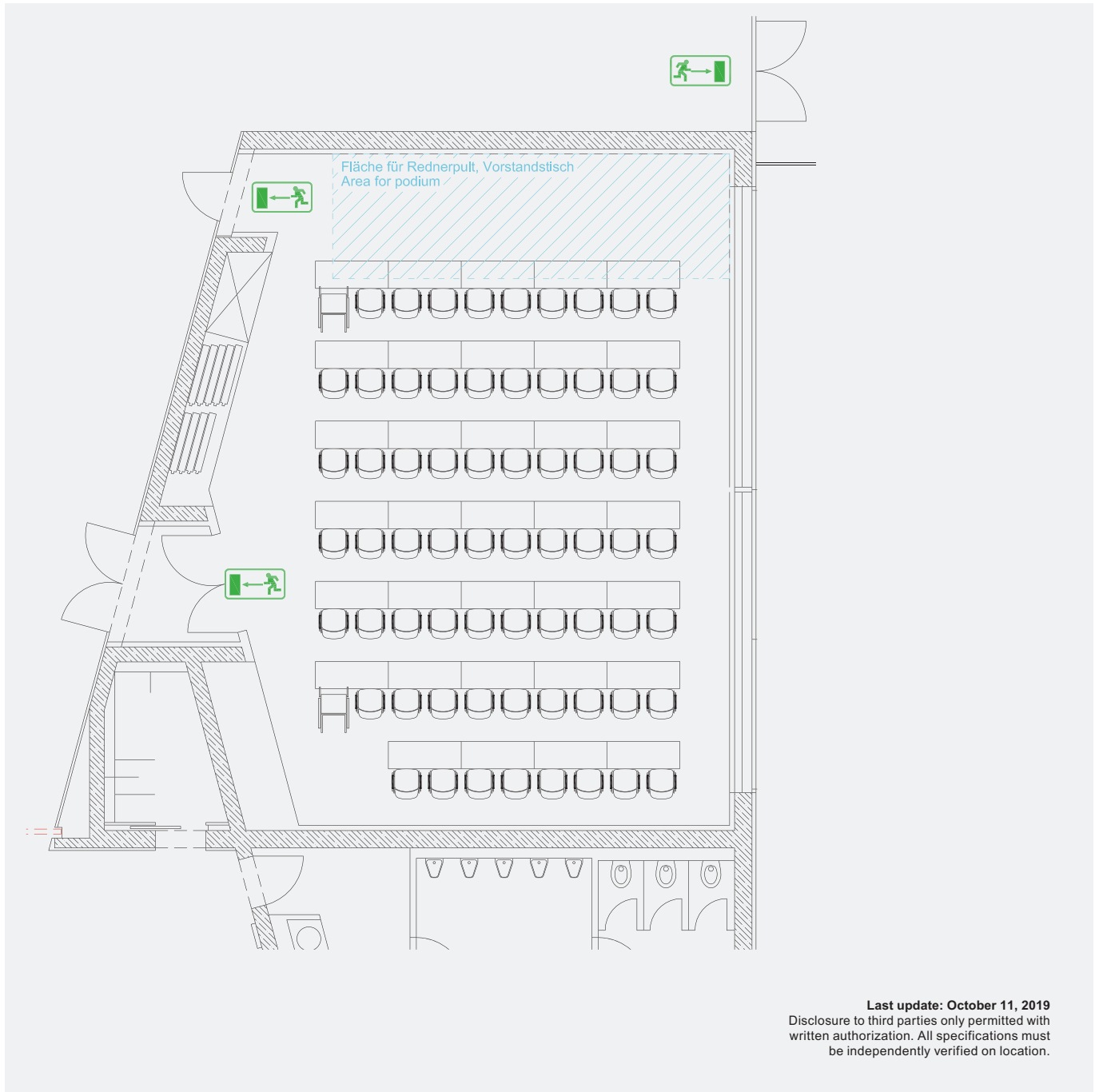

 Escape route

Area in m²

130

 Classroom

68

ICM – International Congress Center Messe München

ROOM 12: BANQUET SEATING

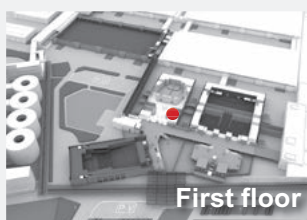
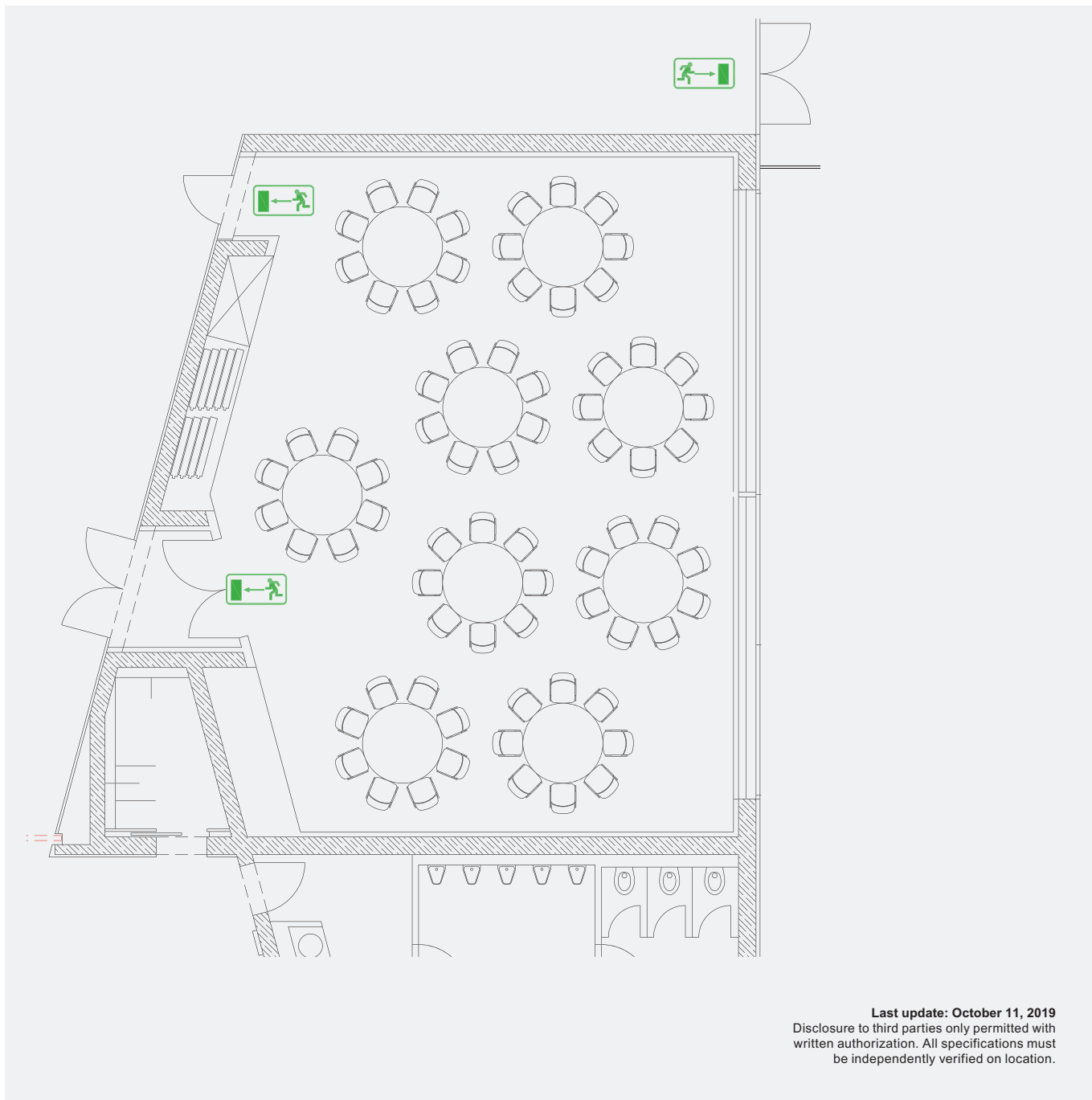

 Escape route

Area in m²

130

 Banquet

72

ICM – International Congress Center Messe München

ROOM 12: U-SHAPED SEATING

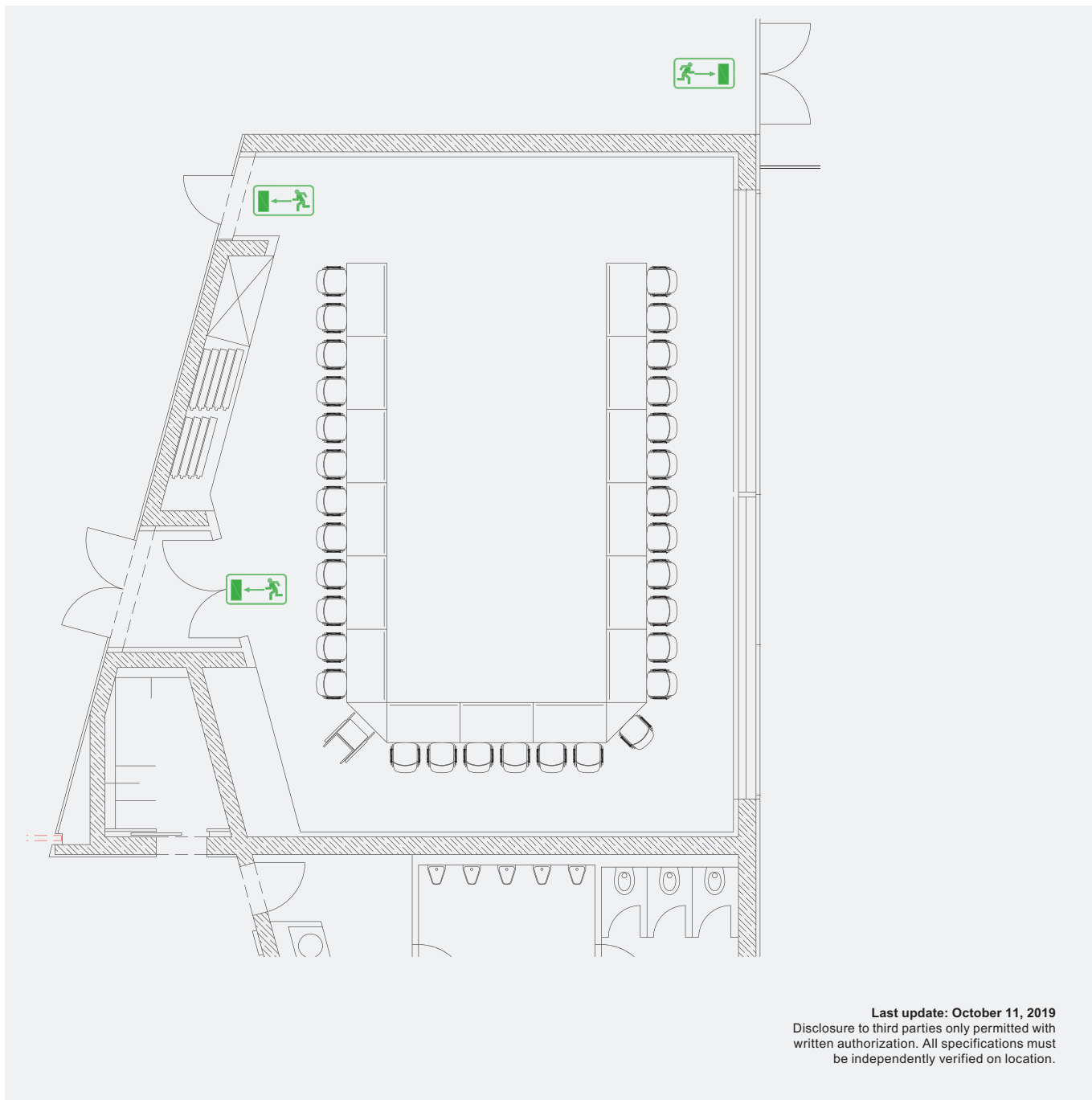

Last update: October 11, 2019
Disclosure to third parties only permitted with
written authorization. All specifications must
be independently verified on location.

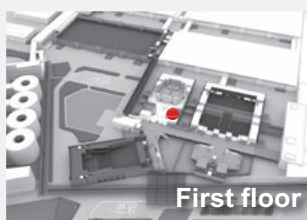

 Escape route

Area in m²

130

 U-shaped

32

ICM – International Congress Center Messe München

ROOM 12: BLOCK SEATING

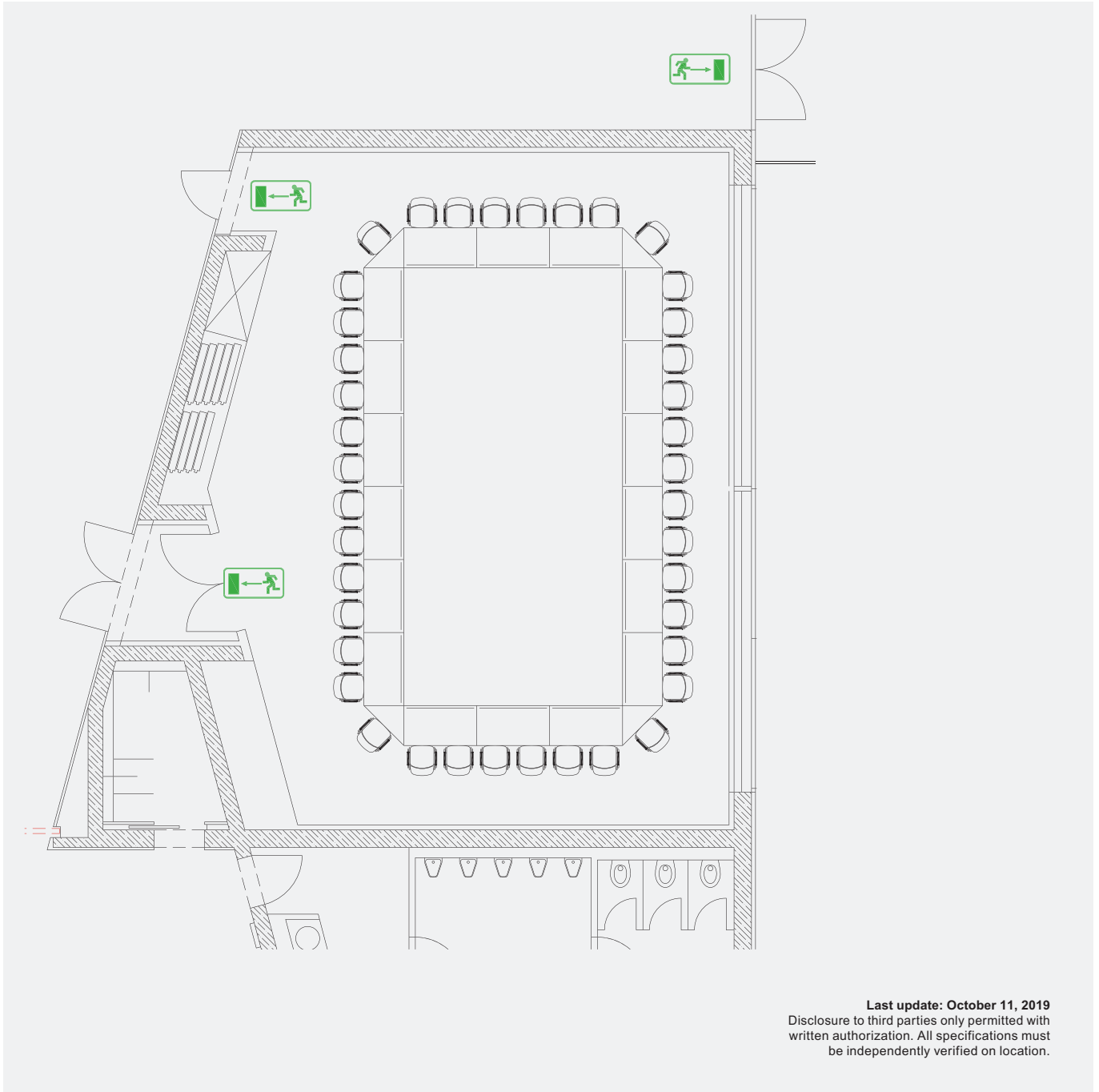

Last update: October 11, 2019
Disclosure to third parties only permitted with
written authorization. All specifications must
be independently verified on location.

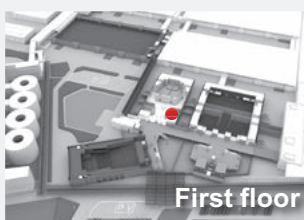

Area in m²

130



40

ICM – International Congress Center Messe München

ROOM 12a: THEATER SEATING

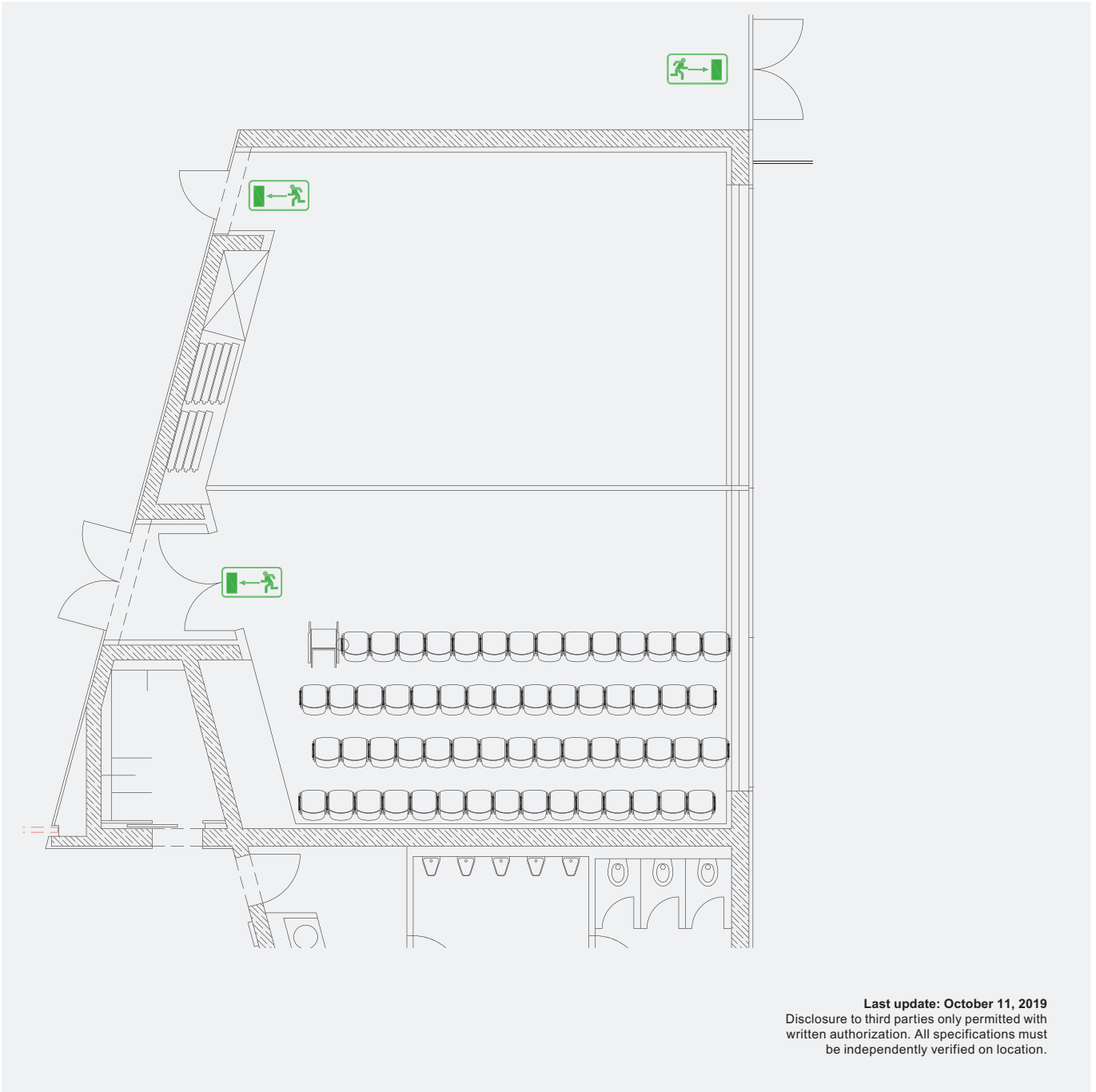

Last update: October 11, 2019
Disclosure to third parties only permitted with written authorization. All specifications must be independently verified on location.

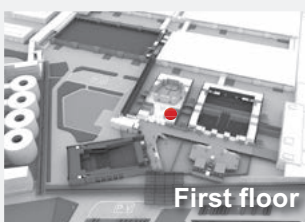

 Escape route

Area in m²

63



Theater

60

ICM – International Congress Center Messe München

ROOM 12a: CLASSROOM SEATING

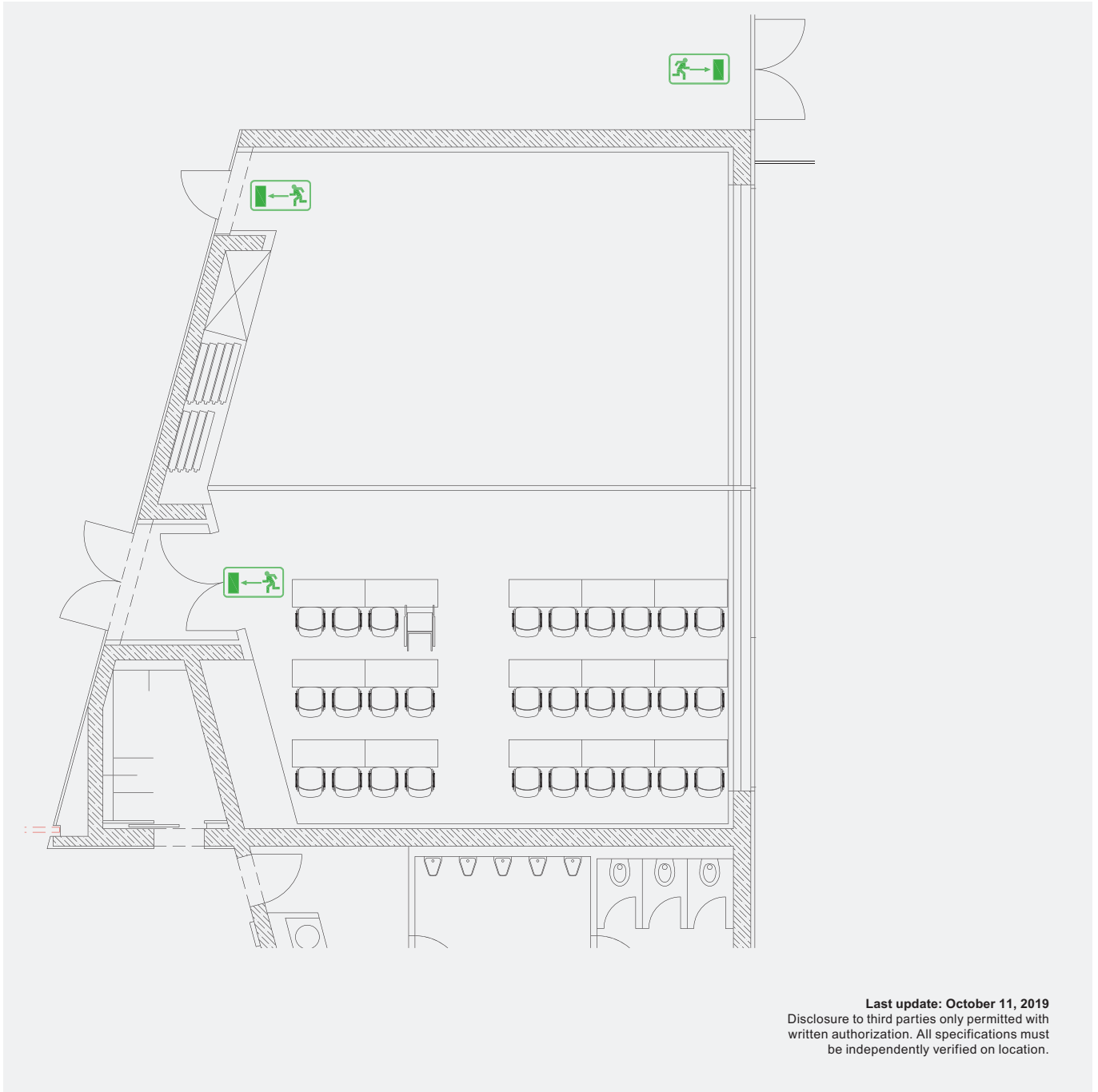

Last update: October 11, 2019
Disclosure to third parties only permitted with
written authorization. All specifications must
be independently verified on location.

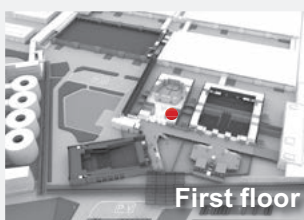

 Escape route

Area in m²

63

 Classroom

30

ICM – International Congress Center Messe München

ROOM 12a: BANQUET SEATING

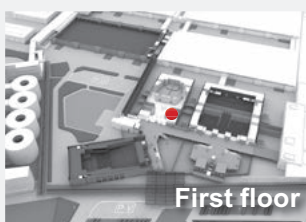
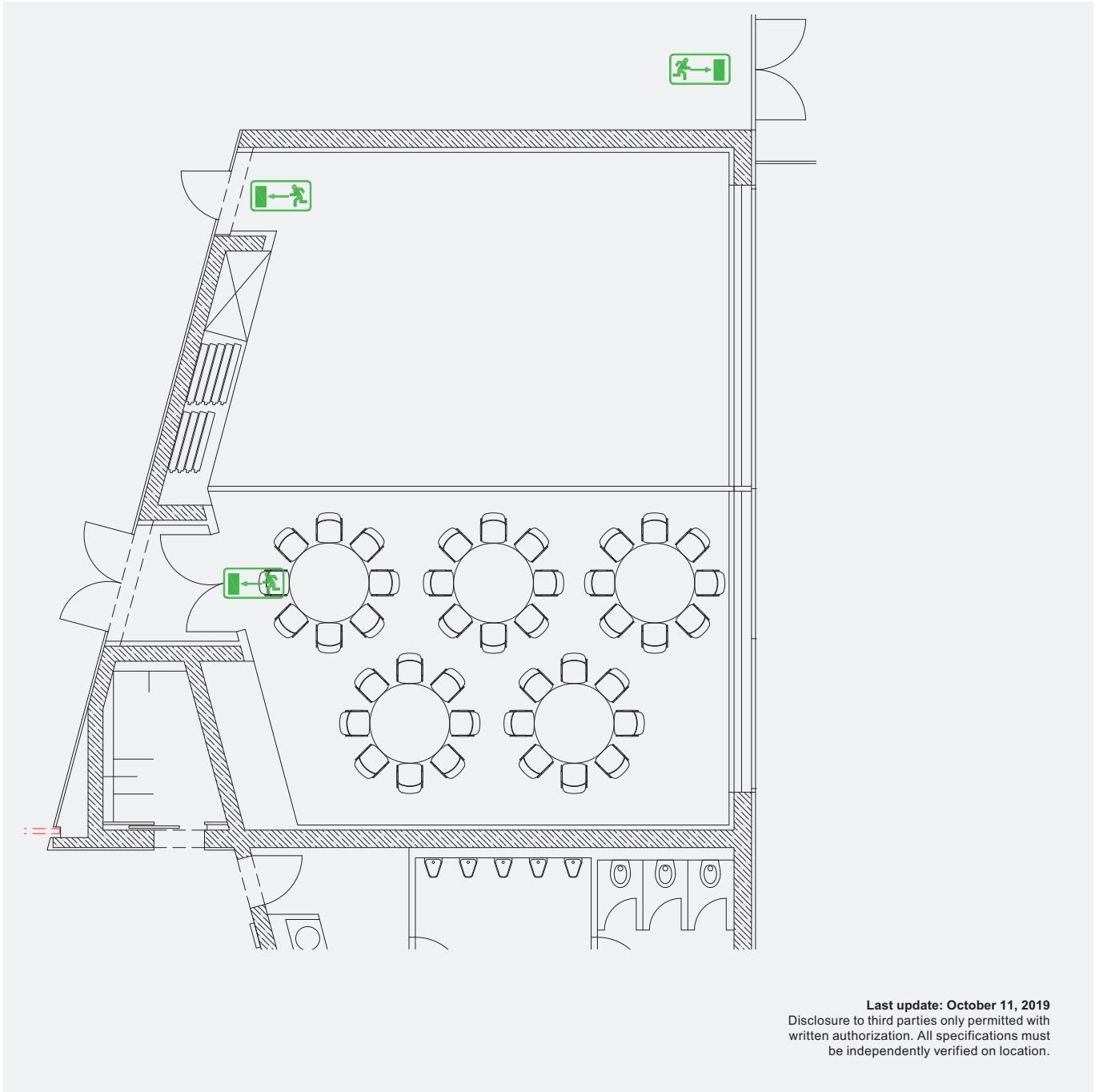

 Escape route

Area in m ²
63

 Banquet
40

ICM – International Congress Center Messe München

ROOM 12a: U-SHAPED SEATING

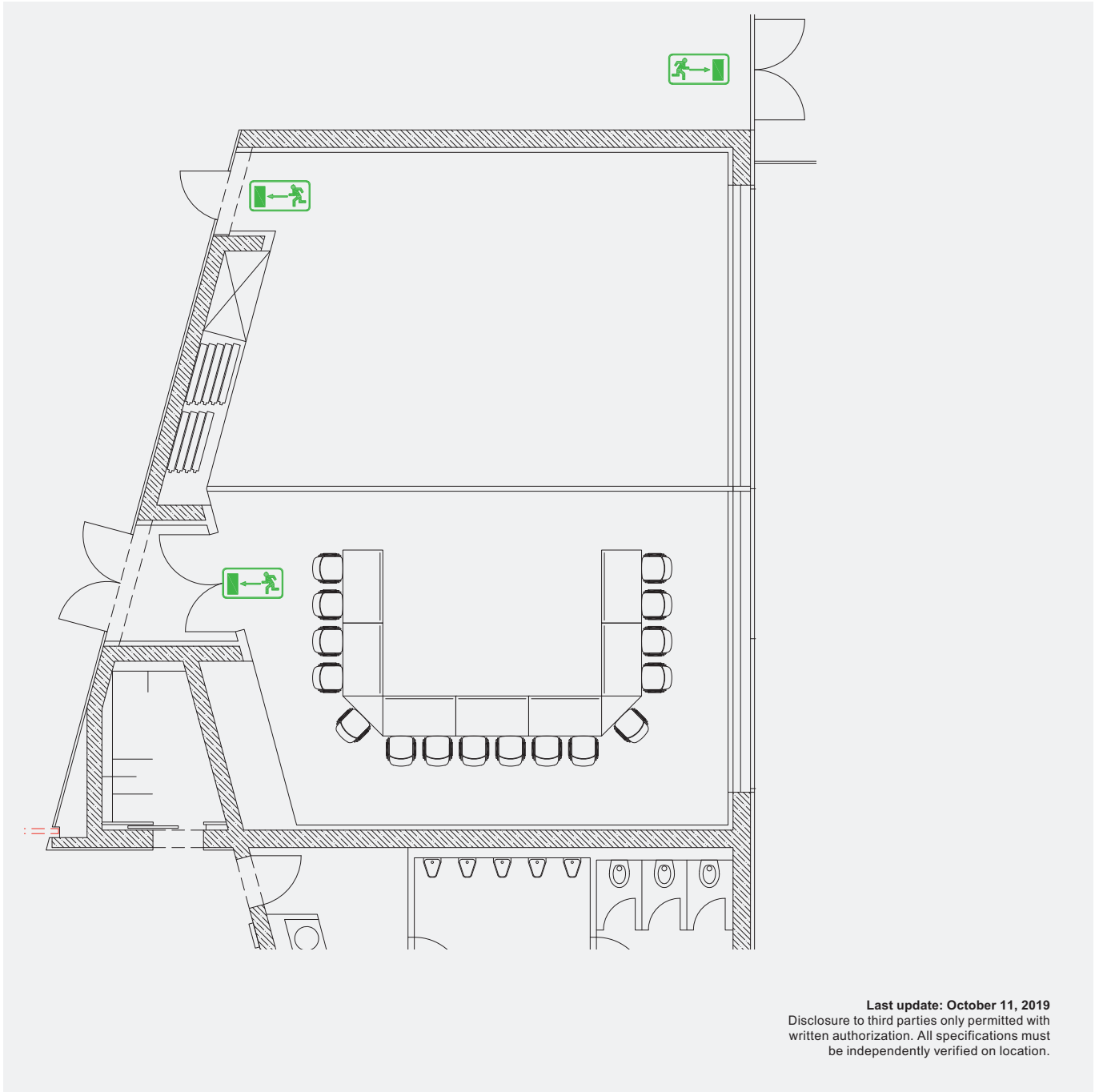

Last update: October 11, 2019
Disclosure to third parties only permitted with
written authorization. All specifications must
be independently verified on location.

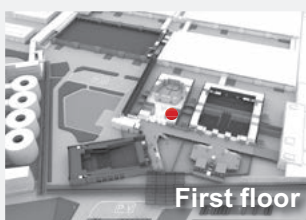

 Escape route

Area in m²

63

 U-shaped

16

ICM – International Congress Center Messe München

ROOM 12a: BLOCK SEATING

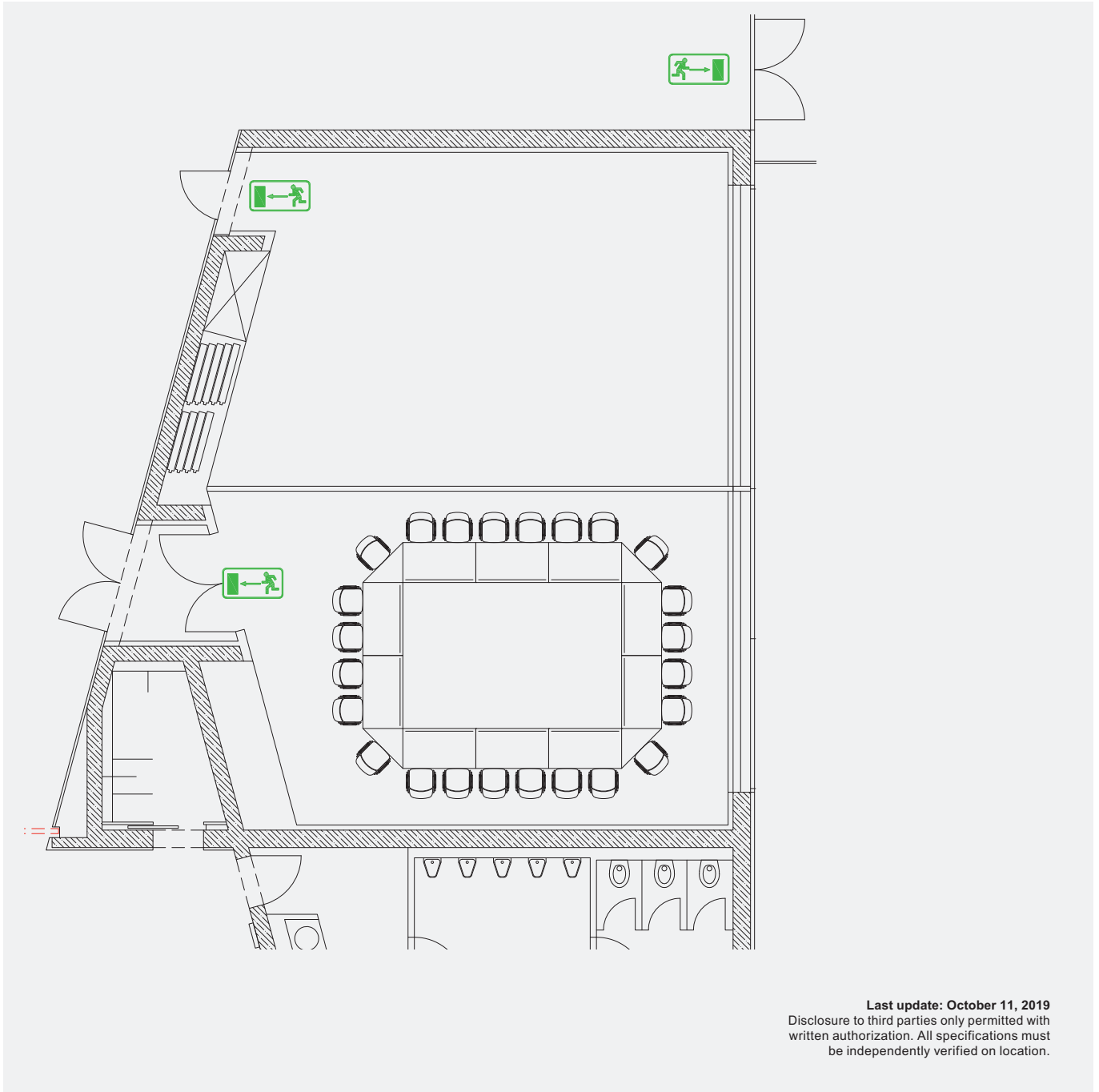

Last update: October 11, 2019
Disclosure to third parties only permitted with
written authorization. All specifications must
be independently verified on location.

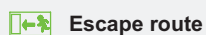
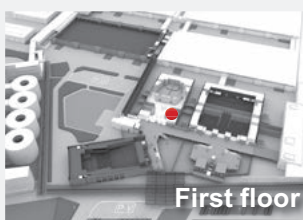

Area in m²

63

 Block

24

ICM – International Congress Center Messe München

ROOM 12b: THEATER SEATING

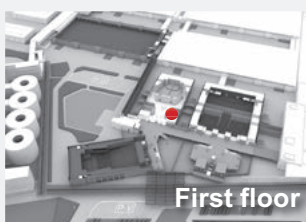
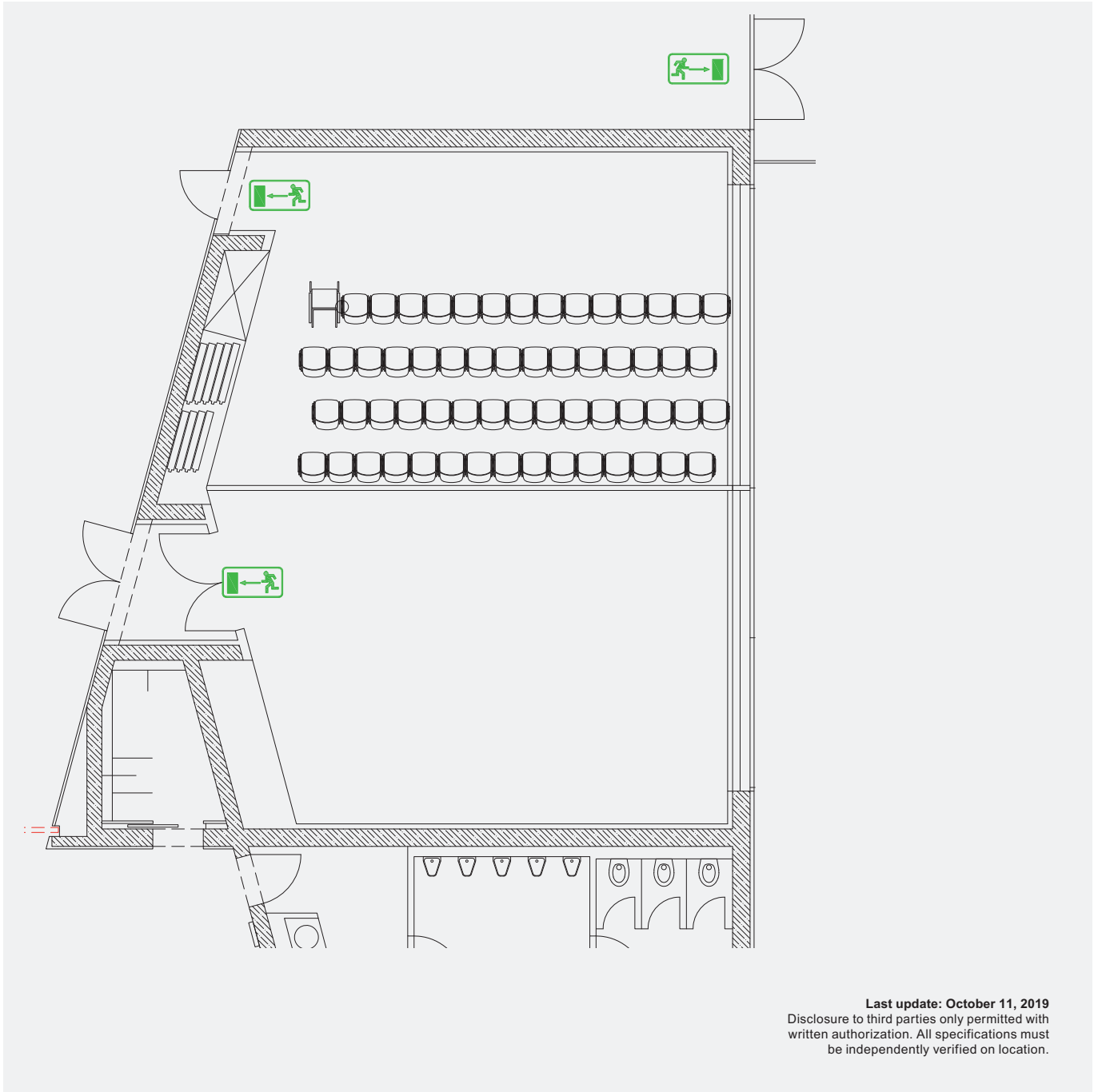

 Escape route

Area in m²

63

 Theater

60

ICM – International Congress Center Messe München

ROOM 12b: CLASSROOM SEATING

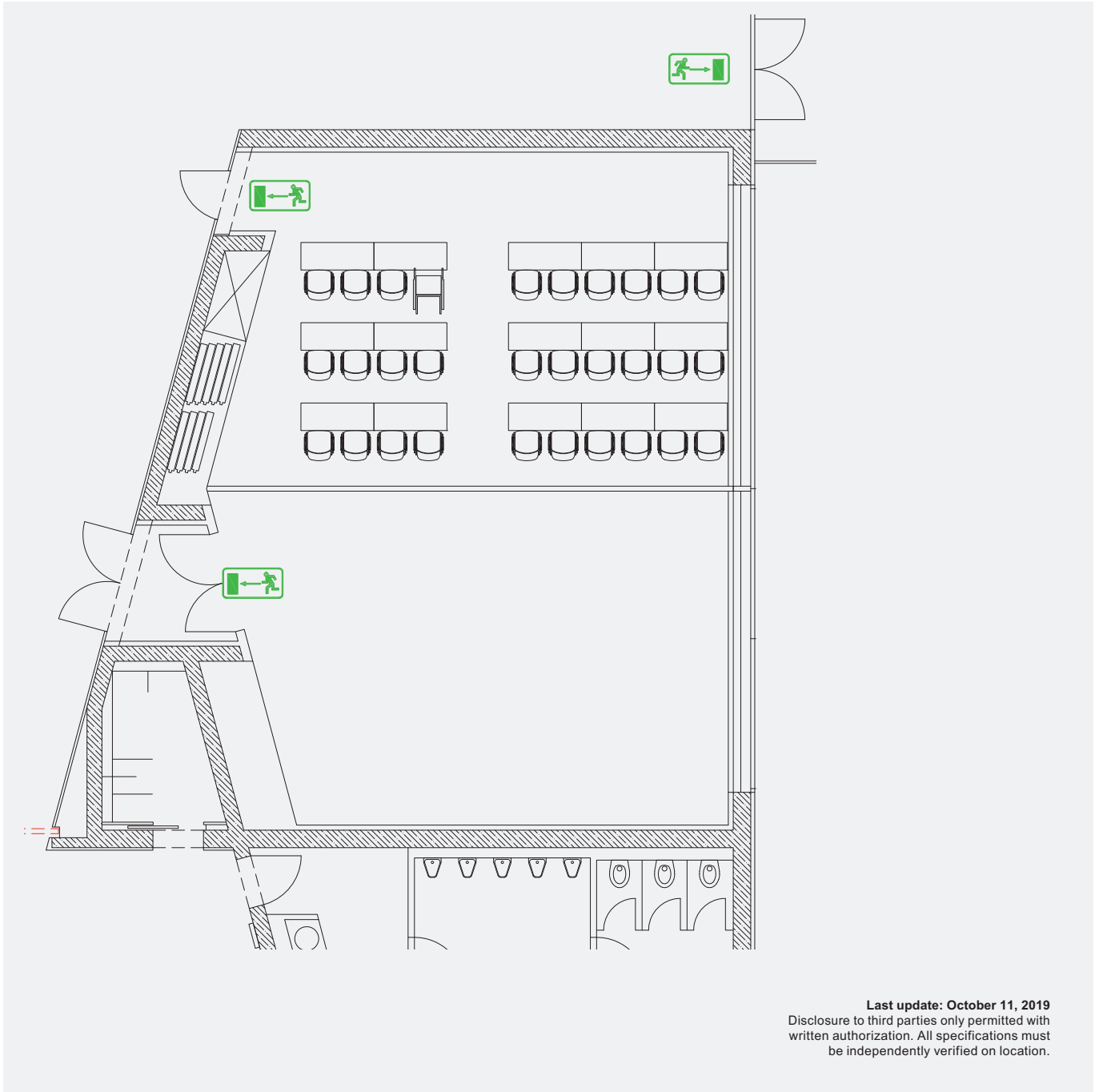

Last update: October 11, 2019
Disclosure to third parties only permitted with written authorization. All specifications must be independently verified on location.

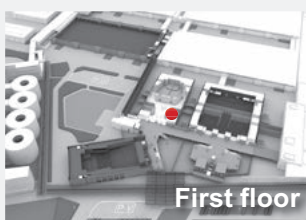

 Escape route

Area in m²

63

 Classroom

30

ICM – International Congress Center Messe München

ROOM 12b: BANQUET SEATING

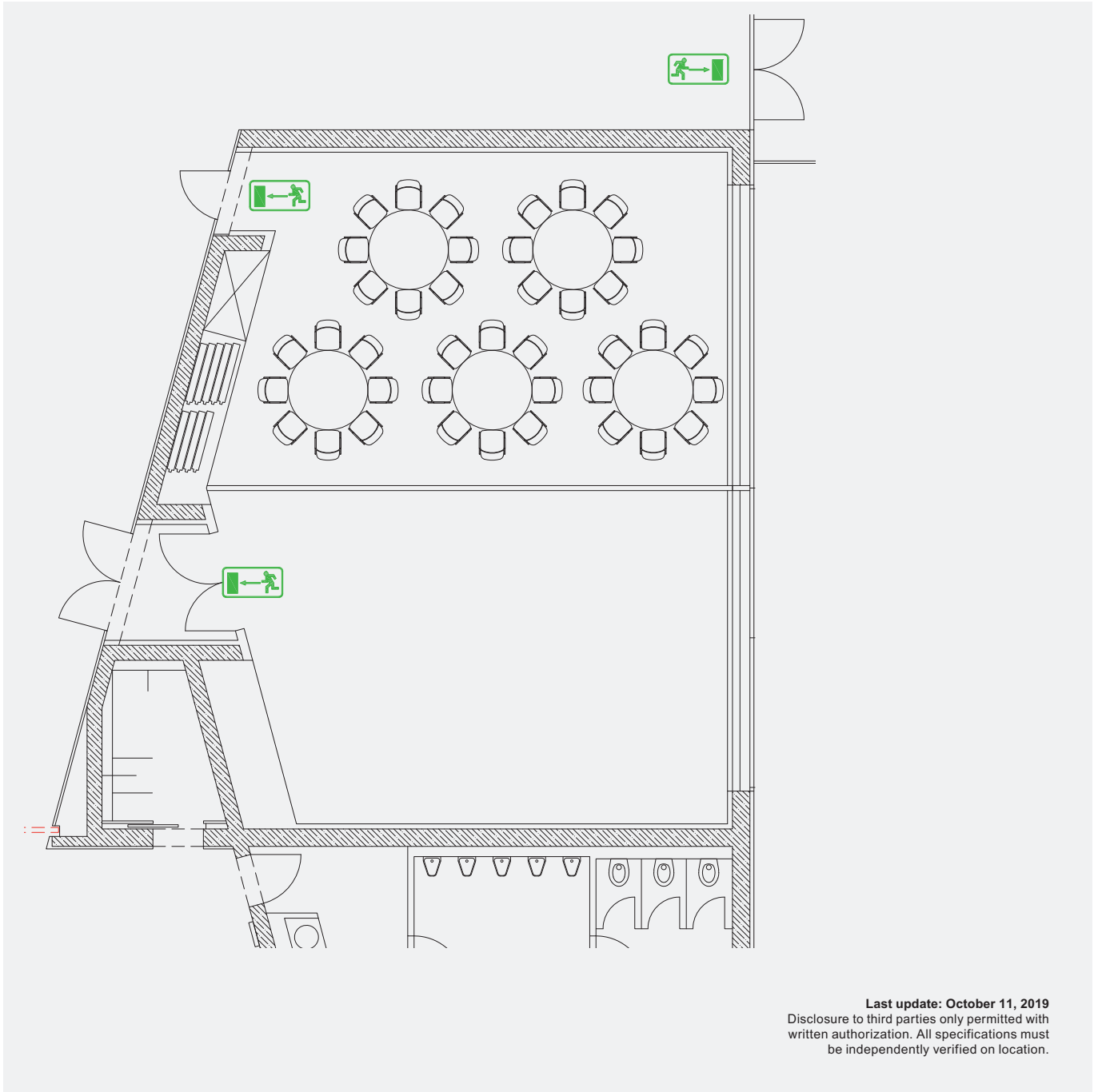

Last update: October 11, 2019
Disclosure to third parties only permitted with
written authorization. All specifications must
be independently verified on location.

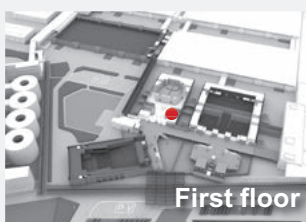

 Escape route

Area in m²

63

 Banquet

40

ICM – International Congress Center Messe München

ROOM 12b: U-SHAPED SEATING

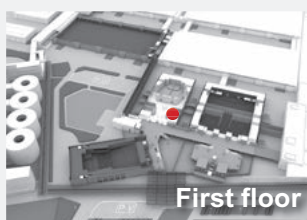
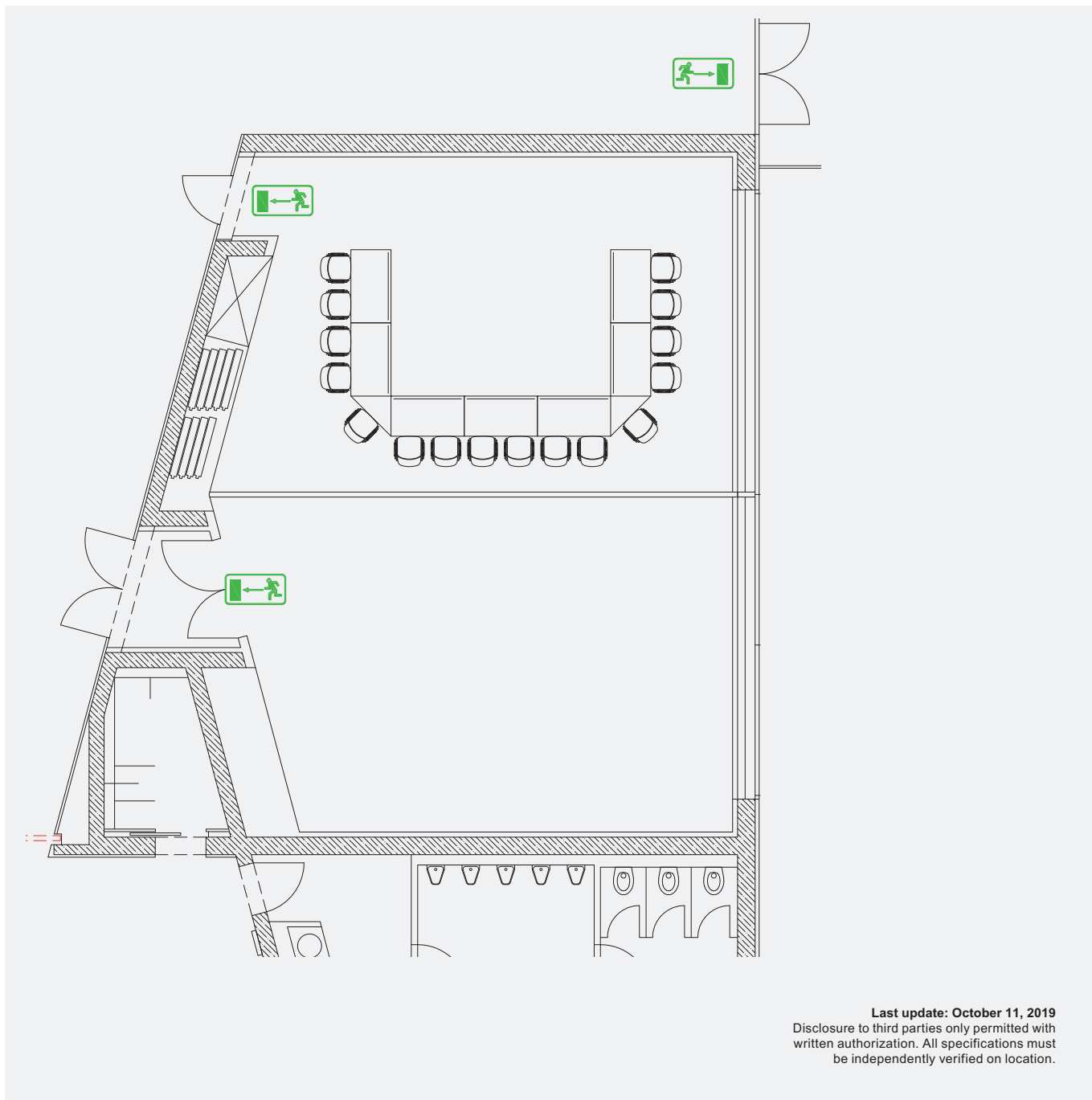

 Escape route

Area in m²

63

 U-shaped

16

ICM – International Congress Center Messe München

ROOM 12b: BLOCK SEATING

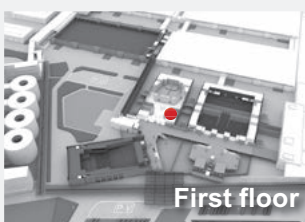
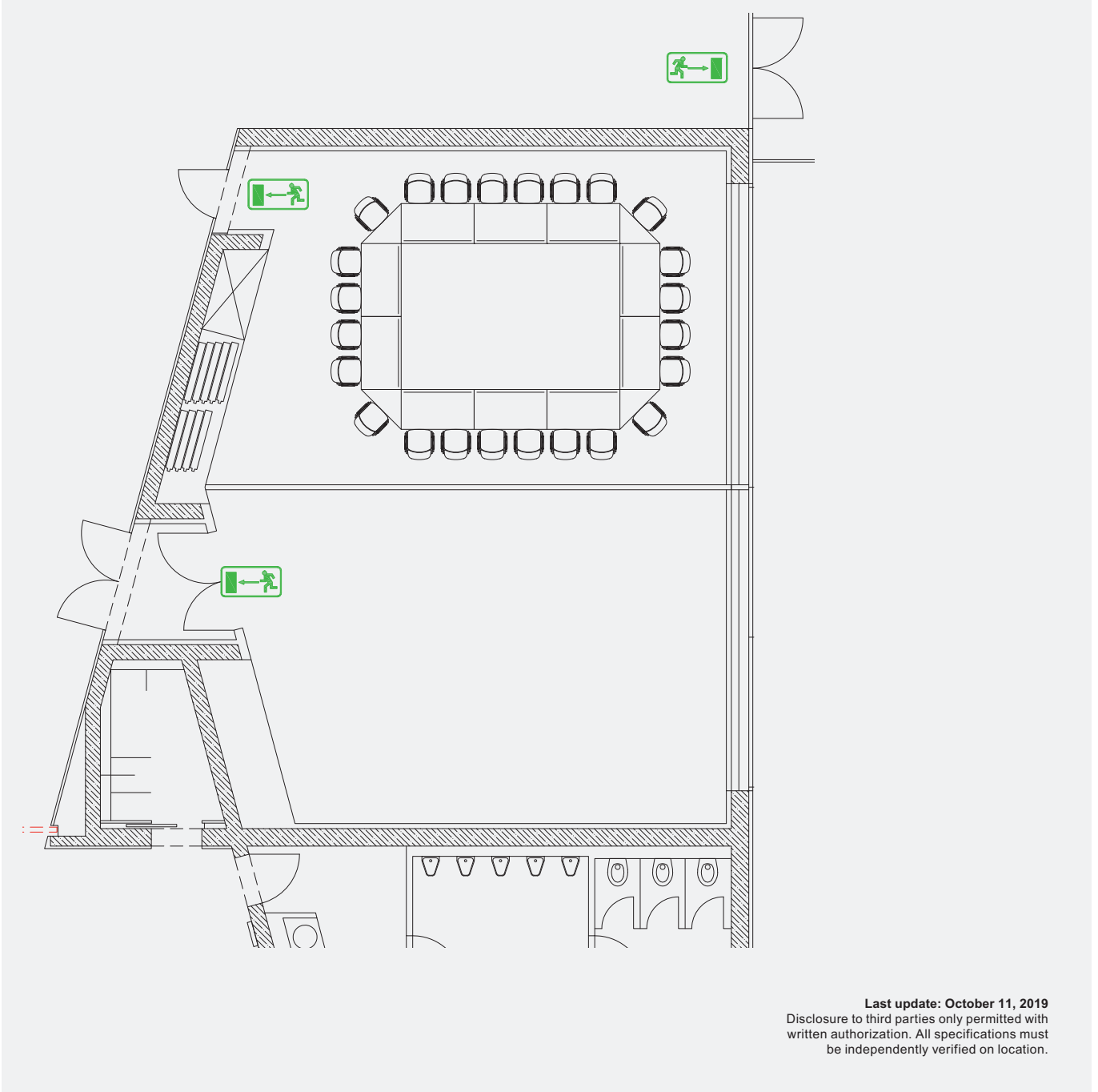

 Escape route

Area in m²

63

 Block

24